

### Building Sketch (Page - 1)

<b>Borrower/Client</b>				
<b>Property Address</b> 15475 Stone Hollow Dr				
<b>City</b>	Huntersville	<b>County</b>	Mecklenburg	<b>State</b> NC <b>Zip Code</b> 28078-6151
<b>Lender</b>	Christina Walker			

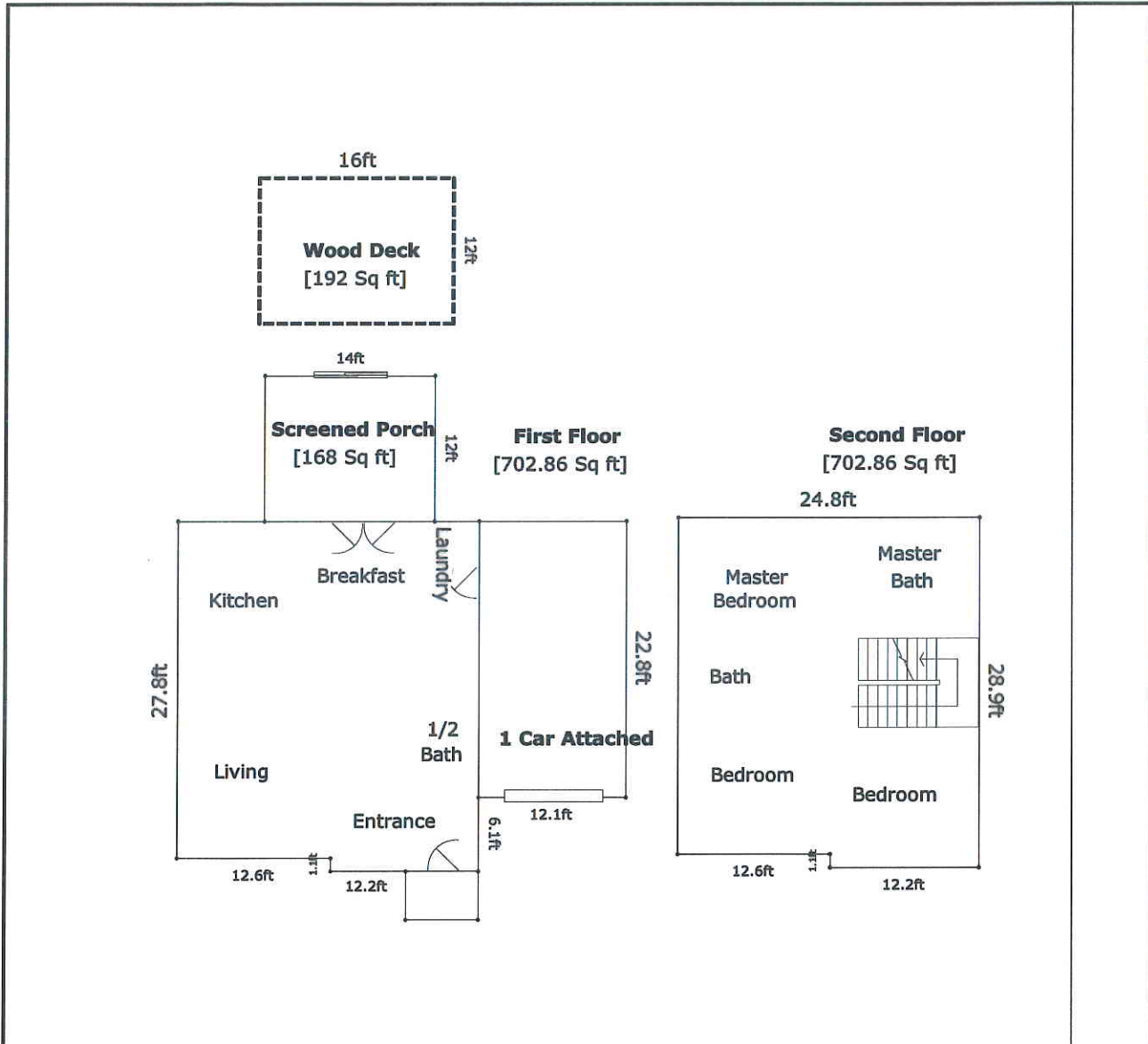

**Area Calculations Summary**

Living Area		Calculation Details	
First Floor	702.9 Sq ft	24.8 x 27.8 = 689.44	
		12.2 x 1.1 = 13.42	
Second Floor	702.9 Sq ft	24.8 x 27.8 = 689.44	
		12.2 x 1.1 = 13.42	
<b>Total Living Area (Rounded):</b>	<b>1406 Sq ft</b>		
<b>Non-living Area</b>			
Screened Porch	168 Sq ft	14 x 12 = 168	
Wood Deck	192 Sq ft	12 x 16 = 192	
1 Car Attached	275.9 Sq ft	22.8 x 12.1 = 275.88	
Covered Stoop	24 Sq ft	6 x 4 = 24	