

**SKETCH**

Borrower  
 Property Address  
 City County State Zip Code  
 Lender/Client

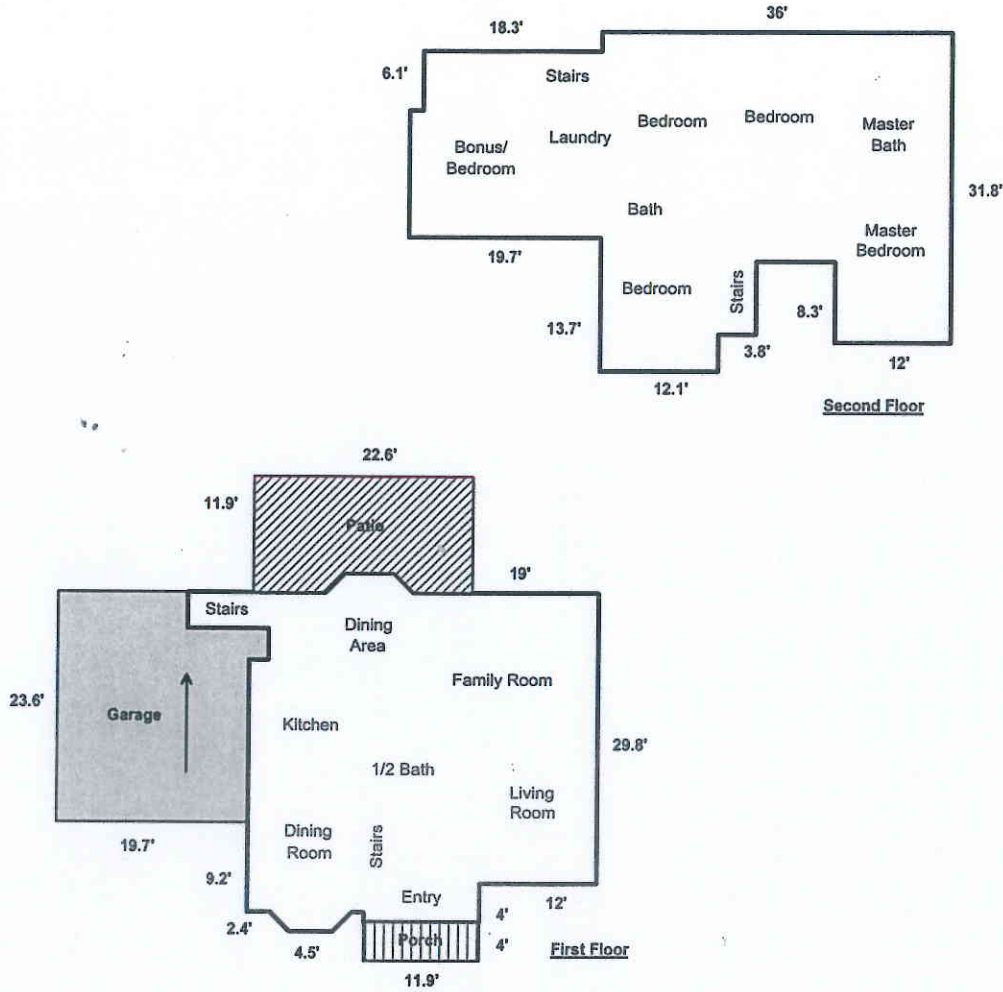

SUMMARY	SQ FT AREA	PERIMETER	AREA CALCULATION DETAILS	
Living Area			First Floor	
First Floor	1201	160	7.1 X 2.0 =	14.2
Second Floor	1478	198	42.4 X 3.7 =	156.8
Total	2679	357	34.0 X 3.2 =	108.8
Porches/Patios			36.0 X 16.7 =	601.2
Patio	255	71	36.0 X 6.2 =	223.2
Porch	48	32	24.0 X 3.0 =	72.0
Garage/Carport			6.5 X 2.0 =	13.0
Attached Garage	447	91	11.9 X 1.0 =	11.9
			Total	1201.1
			Second Floor	
			36.0 X 23.5 =	846.0
			18.3 X 19.1 =	349.5
			1.4 X 13.0 =	18.2
			15.9 X 7.5 =	119.2
			12.0 X 8.3 =	99.6
			12.1 X 3.8 =	45.9
			Total	1478.4