

WELDON LED MARKER LIGHTS
 WHELEN WARNING AND SCENE LIGHTS W/ FLANGES
 WHELEN 52" LIGHTBAR

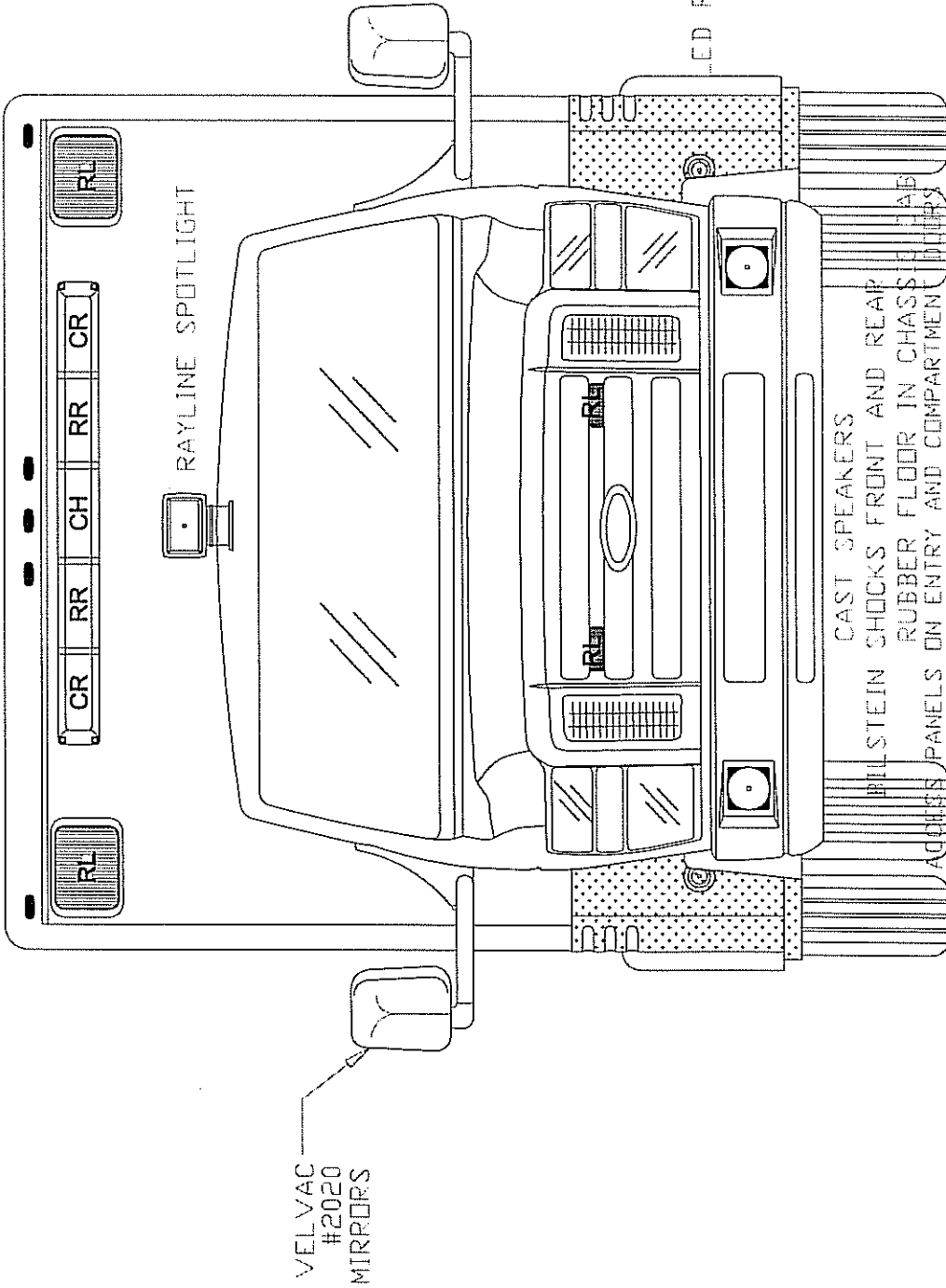

DRAWN BY: MRY	REVISIONS	DRAWING TITLE: FRONT EXTERIOR VIEW - 72" H.R.
DATE: 11/14/08	MARQUE ~ ~ ~ Ambulances	TYPE/MODEL/CHASSIS: TYPE III-164 COMMANDO-FORD E450
<small>Drawing is non-patentable, utility. Dimensions shown are approximate and may vary from the completed vehicle. DO NOT scale this drawing!</small>		DEALER / CUSTOMER: RELIABLE - DEMO
		UNIT NUMBER: 4486
		PRINT NUMBER: 3-164CMDO-001

WELDON LED MARKER LIGHTS
 WHELEN WARNING AND SCENE LIGHTS W/ FLANGES

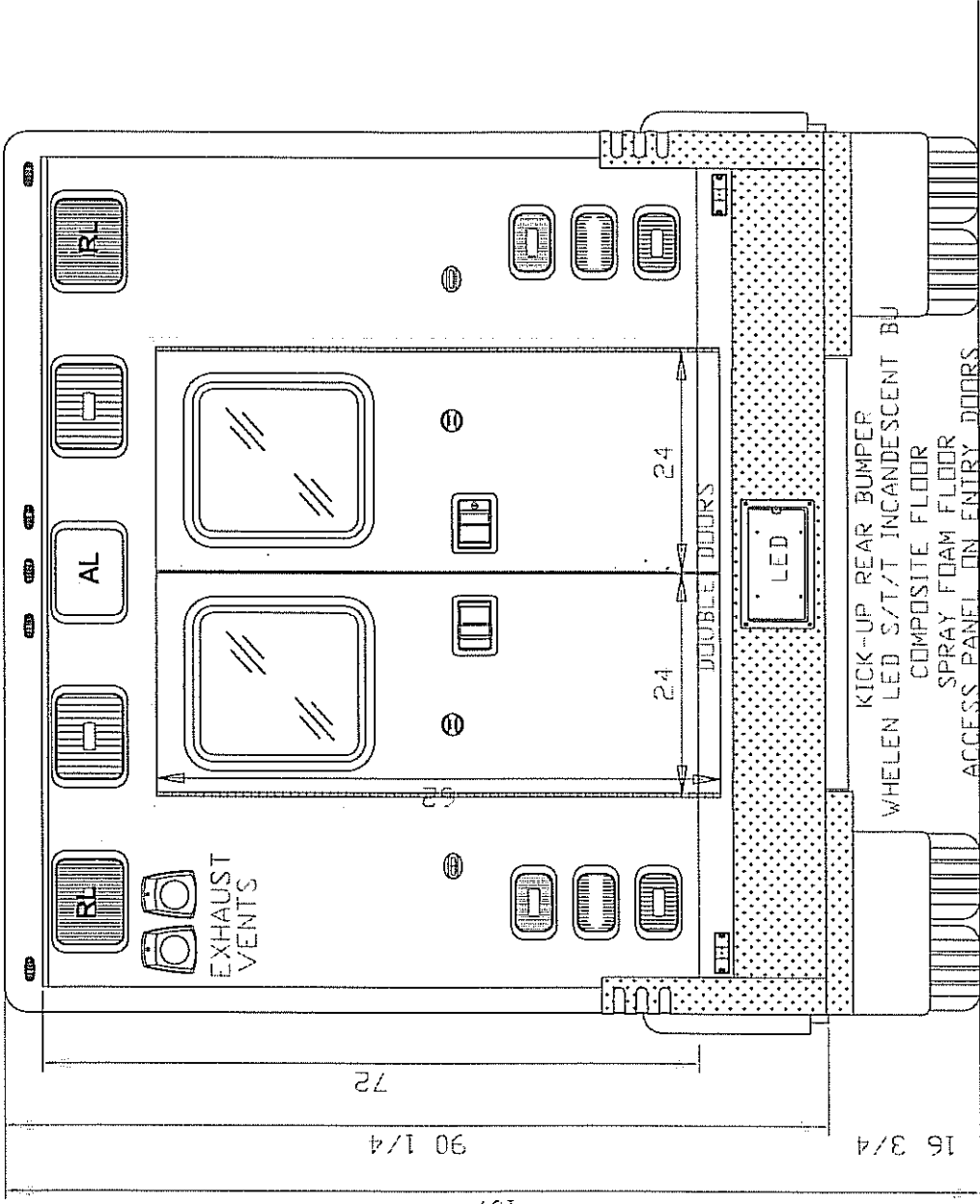

KICK-UP REAR BUMPER
 WHELEN LED S/T/T INCANDESCENT BU
 COMPOSITE FLOOR
 SPRAY FOAM FLOOR
 ACCESS PANEL ON ENTRY DOORS

DRAWN BY: MRY	REVISIONS	DRAWING TITLE: REAR EXTERIOR VIEW - 72' H.R.
DATE: 11/14/08		TYPE/MODEL/CHASSIS: TYPE III-164 COMMANDO-FORD E450
<small>Drawing is representative only - Dimensions shown are approximate and may vary from the completed vehicle DO NOT scale this drawing!</small>		DEALER/CUSTOMER: RELIABLE - DEMO
		UNIT NUMBER: 4486
		PRINT NUMBER: 3-164CMDO-002

MARQUE ~ ~ ~ ~ ~ Ambulances

ACCESS PANELS ON ENTRY AND COMPARTMENT DOORS

WELDON LED MARKER LIGHTS
WHEEL WARNING AND SCENE LIGHTS W/ FLANGES

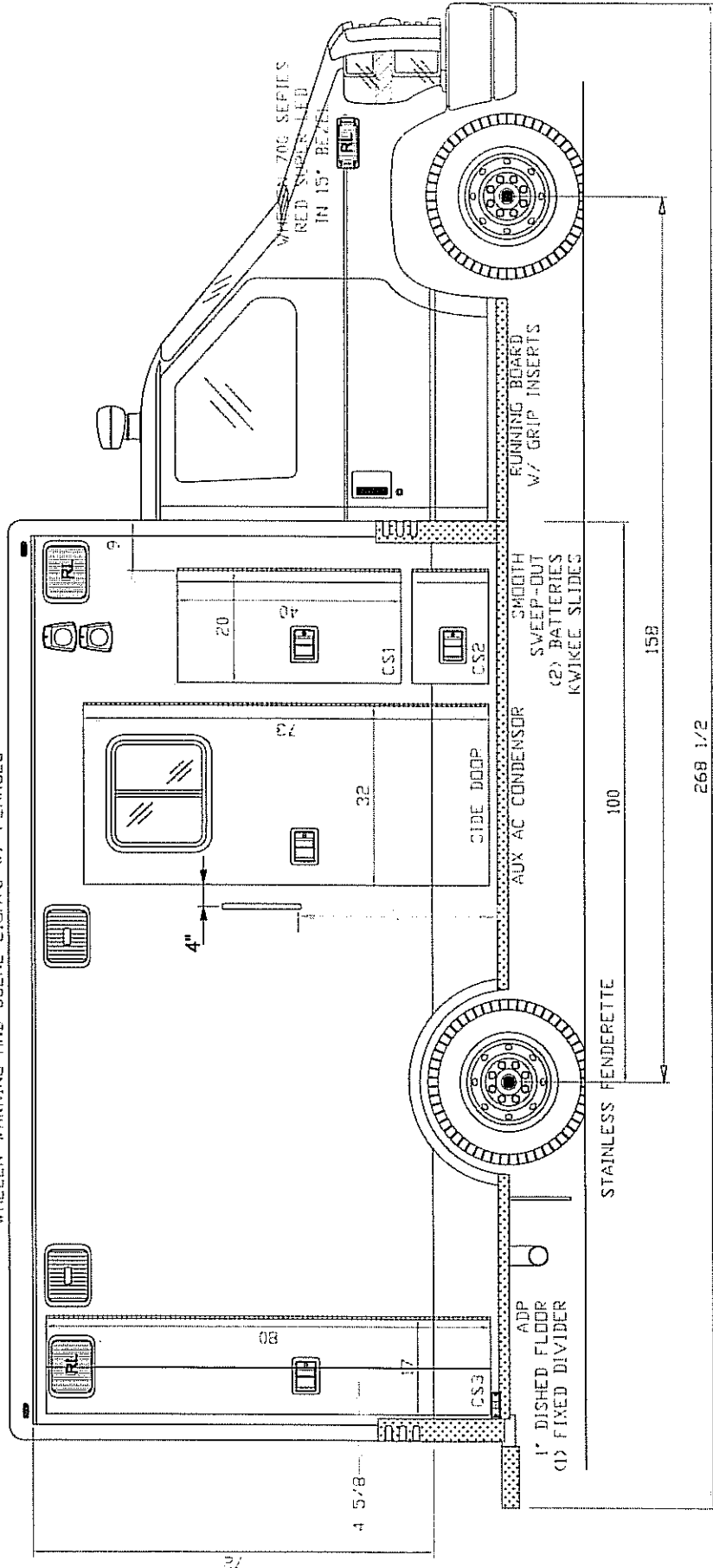

PAINTE WHEELS - NO WHEEL SIMS

DRAWN BY: MRY	REVISIONS
DATE: 11/14/08	MARQUE ~ ~ ~ ~ ~
Drawing is representative only - Dimensions shown are approximate and may vary from the completed vehicle DO NOT scale this drawing!	
DRAWING TITLE: CURBSIDE EXTERIOR VIEW - 72" H.R.	
TYPE/MODEL/CHASSIS: TYPE III-164 COMMANDO-FORD E450	
DEALER / CUSTOMER: RELIABLE - DEMO	
UNIT NUMBER: 4486	PRINT NUMBER: 3-164CMDO-003

DUCTED
HEAT/AC

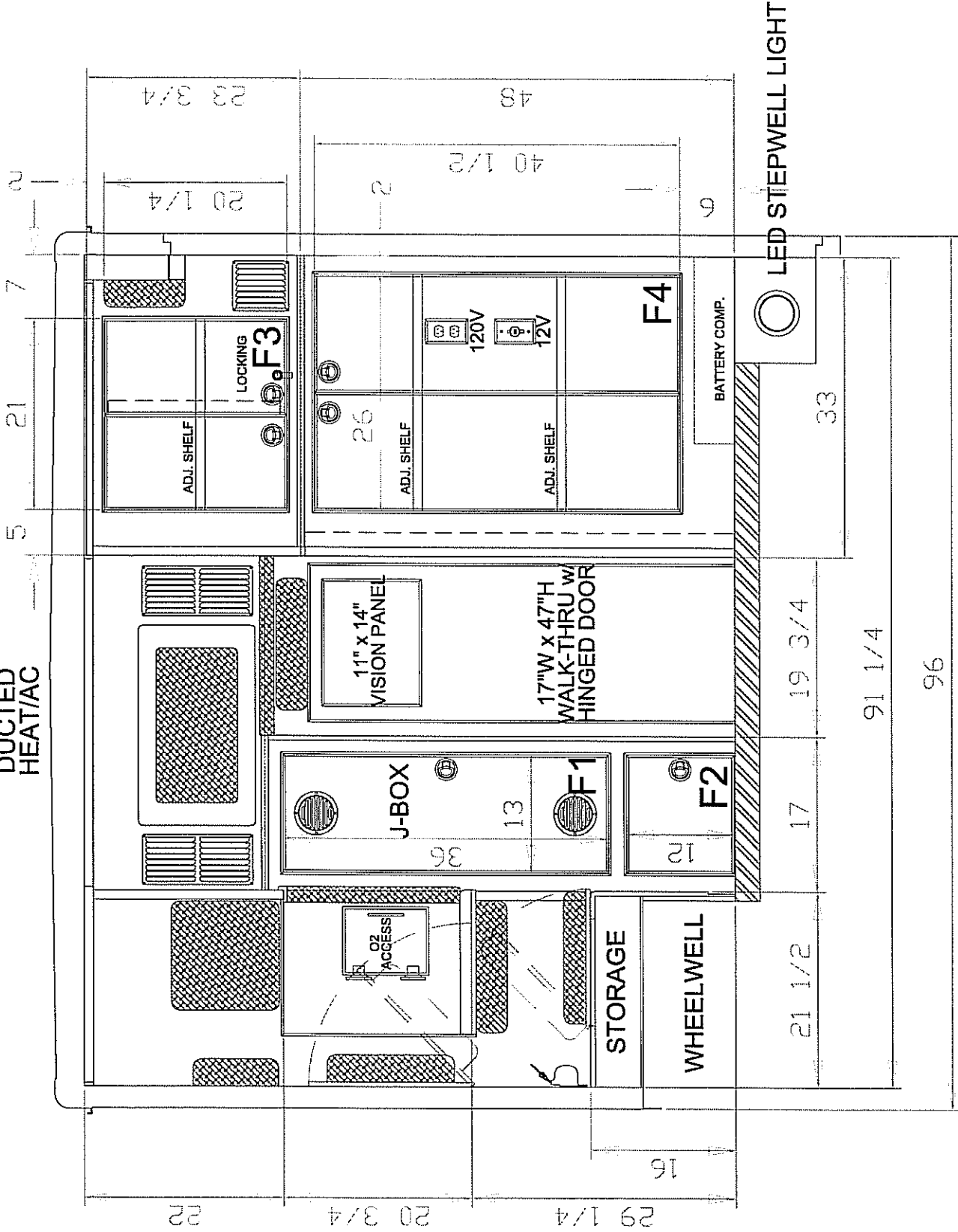

DRAWN BY: MRY

DATE: 11/18/08

Drawing is representative only - Dimensions shown are approximate and may vary from the completed vehicle DO NOT scale this drawing!

REVISIONS

MARQUE ~ ~ ~ Ambutances

DRAWING TITLE: FRONT INTERIOR VIEW - 72" H.I.R.

MODEL/TYPE/CHASSIS: TYPE III - 164 COMMANDO

DEALER / CUSTOMER: RELIABLE - DEMO

UNIT NUMBER: 4486

PRINT NUMBER: T3-164CMDO-005

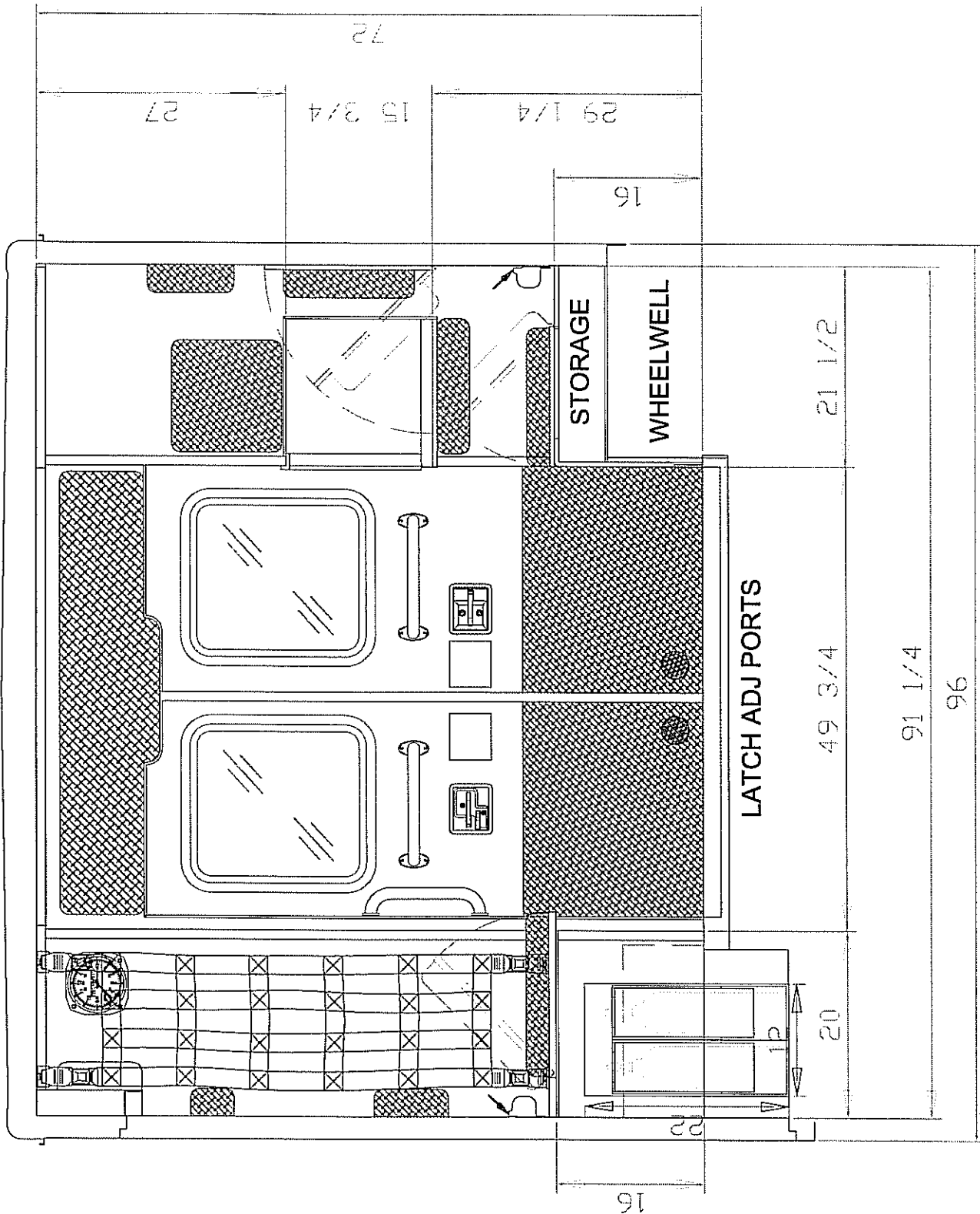

DRAWING TITLE: REAR INTERIOR VIEW - 72" H.R.
 MODEL/TYPE/CHASSIS: TYPE III - 164 COMMANDO
 DEALER / CUSTOMER: RELIABLE - DEMO
 UNIT NUMBER: 4486 | PRINT NUMBER: T3-164CMD0-006

MARQUE ~ ~ ~ *Amortances*

DRAWN BY:	MR Y	REVISIONS
DATE:	11/18/08	
<small>Drawing is representative only. Dimensions shown are approximate and may vary from the completed vehicle. DO NOT scale this drawing!</small>		

164

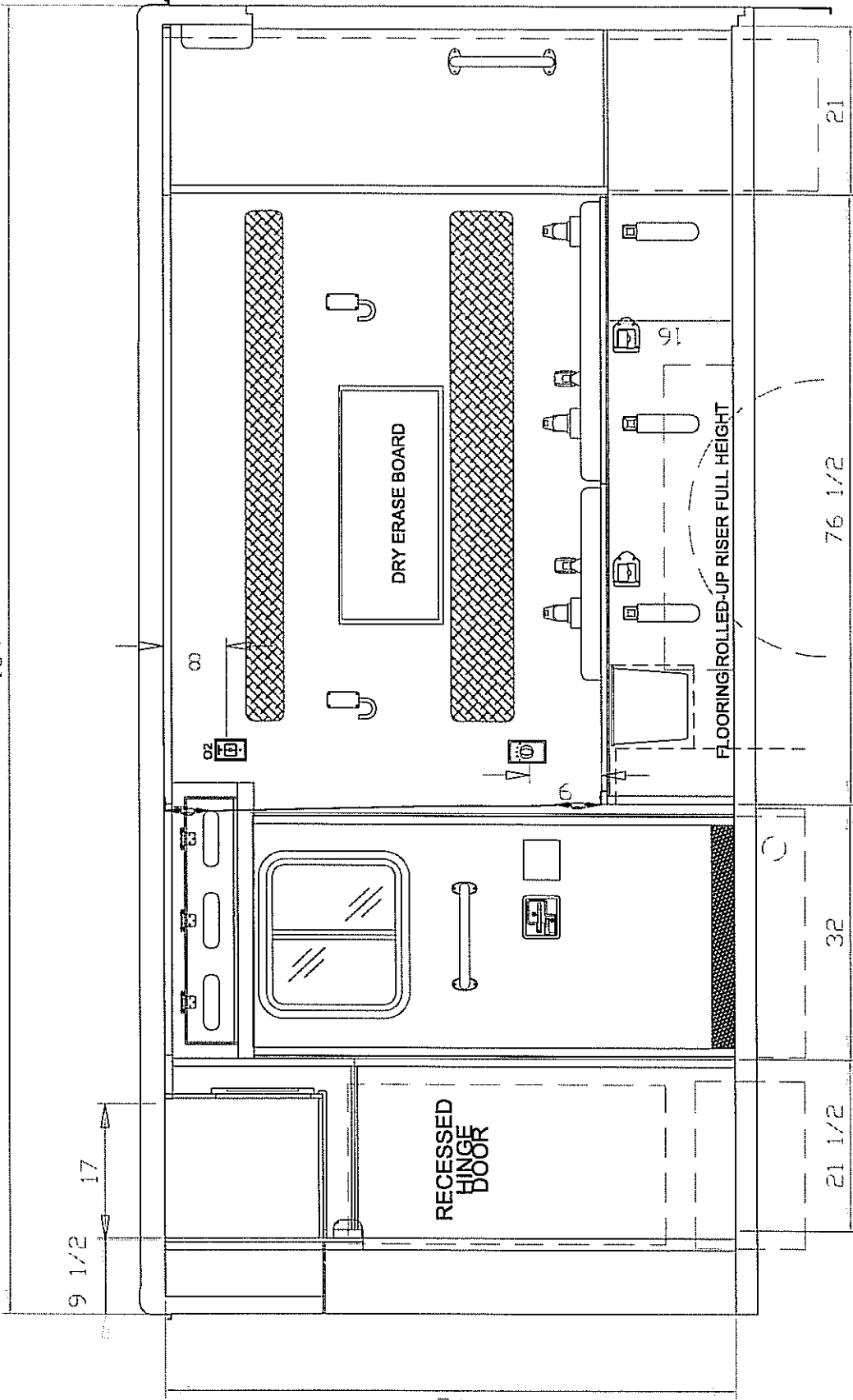

72

DRAWING TITLE: CURBSIDE INTERIOR VIEW - 72' H.I.R.
 MODEL/TYPE/CHASSIS: TYPE III - 164 COMMANDO
 DEALER / CUSTOMER: RELIABLE - DEMO
 UNIT NUMBER: 4486 | PRINT NUMBER: T3-164CMDO-007

MARQUE ~ ~ ~  AMBUANCES

DRAWN BY:	MRY	REVISIONS
DATE:	11/18/08	
<small>Drawing is representative only - Dimensions shown are approximate and may vary from the completed vehicle. DO NOT scale this drawing!</small>		

164

100

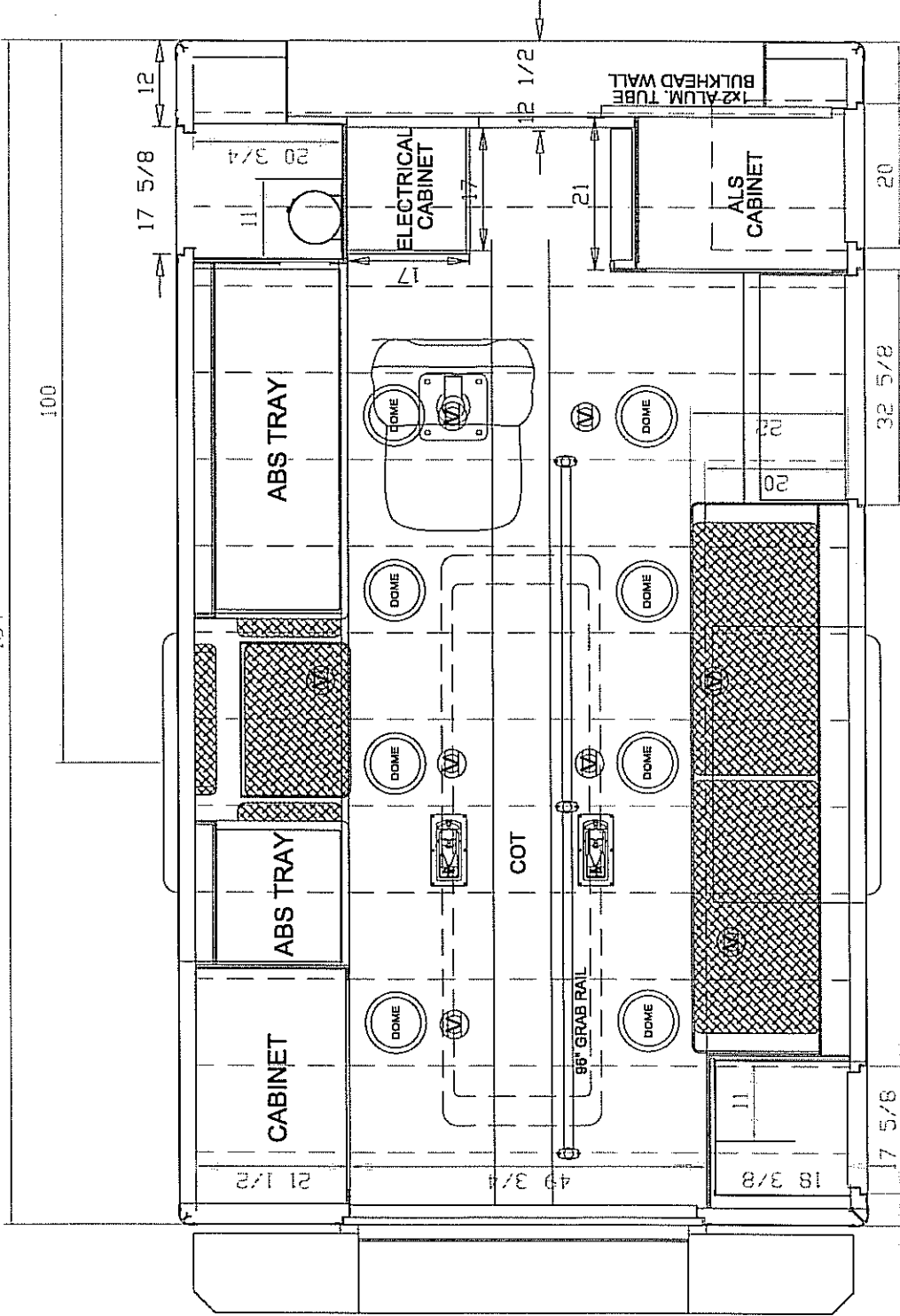

8 1/2

4 1/2

DRAWN BY: MRY	REVISIONS
DATE: 11/19/08	
Drawing is representative only - Dimensions shown are approximate and may vary from the completed vehicle DO NOT scale this drawing!	
DRAWING TITLE: FLOOR PLAN	
TYPE/MODEL/CHASSIS: TYPE III - 164 COMMANDO	
DEALER/CUSTOMER/RELIABLE - DEMO	
UNIT NUMBER: 4486	PRINT NUMBER: T3-164CMDO-009

MARQUE ~ Ambulances

REV	DATE	BY	EN	REV	DATE	BY	EN	REV	DATE	BY	EN

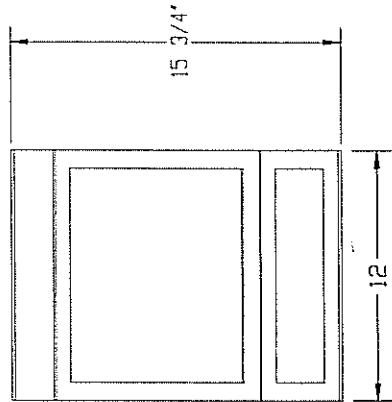

CHANGED TO 12" WIDE...NEW STANDARD

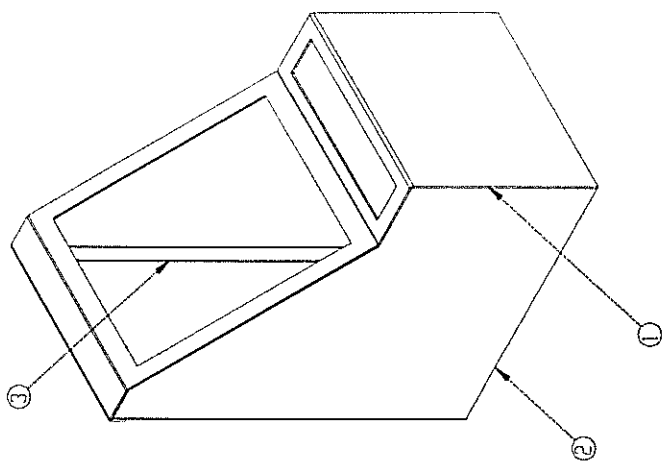
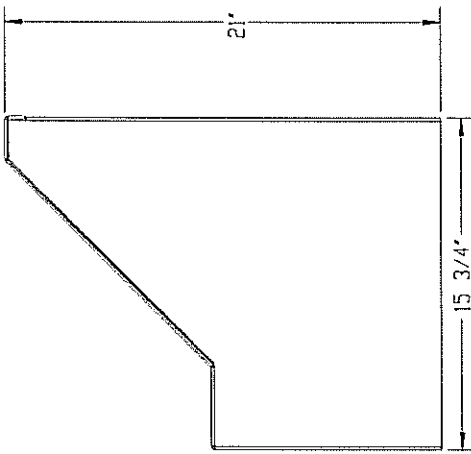
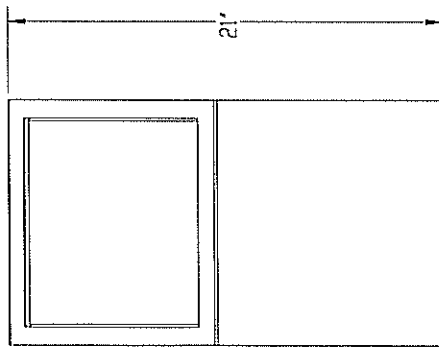

AFTER WELDING GRIND ALL WELDS SMOOTH FOR THIS IS MULTISPEC PAINTED

ITEM NO.	QTY.	PART NO.	DESCRIPTION
1	1	11-0027-1	TYPE III 164 COMMANDO FRONT CONSOLE BODY
2	1	11-0027-2	TYPE III 164 COMMANDO FRONT CONSOLE SIDE PANEL 1
3	1	11-0027-3	TYPE III 164 COMMANDO FRONT CONSOLE SIDE PANEL 2

PROJECTION	EXPLANATION
⊙	TYPE III 164 COMMANDO FRONT CONSOLE
⊙	MATERIAL
⊙	SEE BOM
⊙	SIZE
⊙	DO NOT SCALE

THIS DRAWING AND THE INFORMATION CONTAINED HEREIN ARE THE EXCLUSIVE PROPERTY OF VAV GROUP. IT SHALL NOT BE COPIED OR REPRODUCED IN ANY MANNER WITHOUT THE WRITTEN PERMISSION OF VAV GROUP. ANY ATTEMPT TO COPY OR UNDER CONTRACT WITH OR PROFESSIONAL SUBMITTED TO VAV GROUP, UNLESS OTHERWISE SPECIFIED IN VAV GROUP.

SJC IND

110 D1 DRIVE
ELKHART, IN 46514
(574) 264-7581
VAVCORP/MILLER/CO

DATE: 7/31/06
DRAWN: AMC
CHECKED: [blank]
DATE: [blank]
SHEET 1 OF 1
DWG REFERENCE: [blank]

11-0027-0

CHANGED TO 12" WIDE
NEW STANDARD

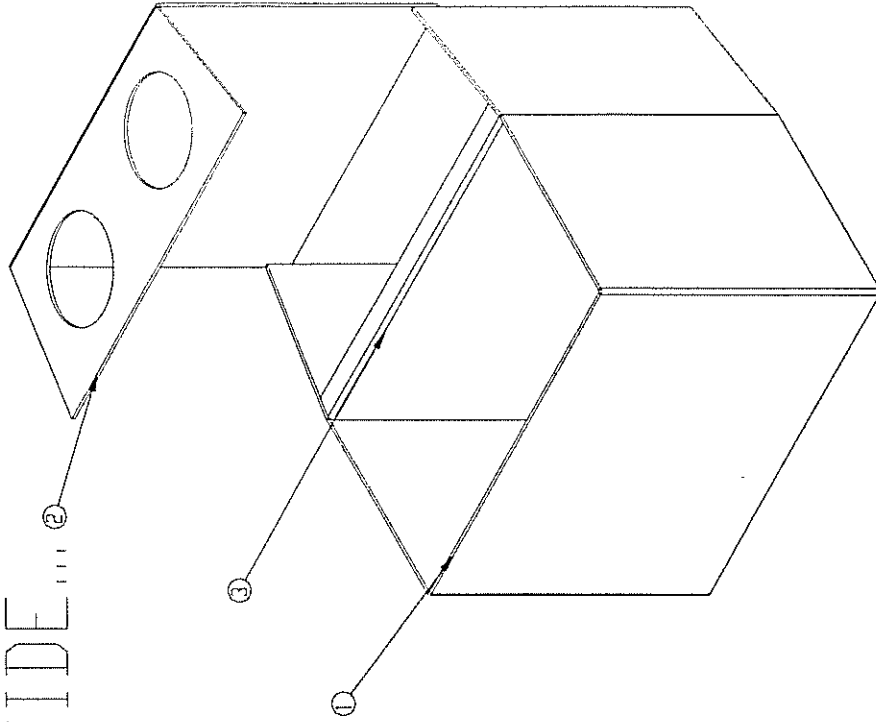
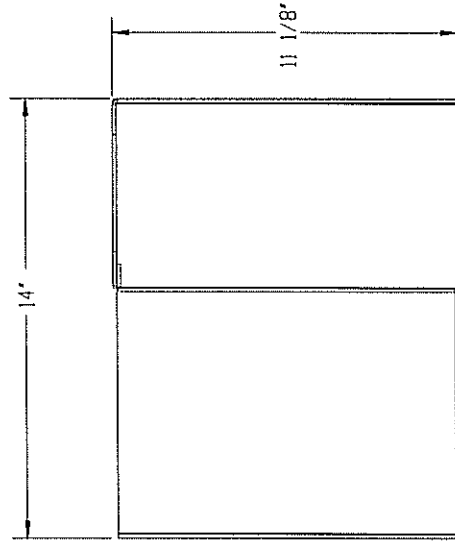
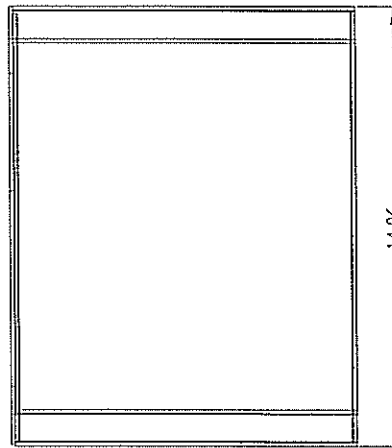
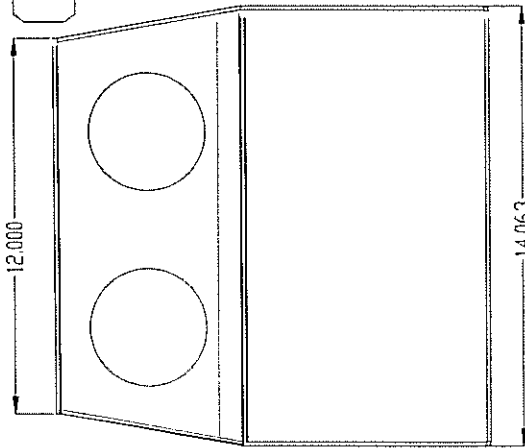

REV	DATE	BY	ECN	REV	DATE	BY	ECN

ITEM NO.	QTY.	PART NO.	MATERIAL	DESCRIPTION
1	1	11-0028-1	Aluminum 1/8"	TYPE III 164 COMMANDO MAP BOOK HOLDER BODY
2	1	11-0028-2	Aluminum 1/8"	TYPE III 164 COMMANDO MAP BOOK HOLDER CUP HOLDER PANEL
3	1	11-0028-3	Aluminum 1/8"	TYPE III 164 COMMANDO MAP BOOK HOLDER CLOSE OFF

PROJECTION: THIRD ANGLE
 SCALE: 1:1
 TOLERANCES: ±.010
 UNITS: INCHES
 CHECKED: DATE: 8/3/06
 DRAWN: ANC
 SHEET 1 OF 4
 UNLESS OTHERWISE SPECIFIED

DESCRIPTION: TYPE III 164 COMMANDO MAP BOOK HOLDER ASSY.
 MATERIAL: SEE BOM
 THIS DRAWING AND THE INFORMATION CONTAINED HEREIN ARE THE EXCLUSIVE PROPERTY OF VAV GROUP, INC. NO PART OF THIS DRAWING OR INFORMATION CONTAINED HEREIN SHALL BE REPRODUCED OR TRANSMITTED IN ANY FORM OR BY ANY MEANS, ELECTRONIC OR MECHANICAL, INCLUDING PHOTOCOPYING, RECORDING, OR BY ANY INFORMATION STORAGE AND RETRIEVAL SYSTEM, WITHOUT THE WRITTEN CONSENT OF VAV GROUP. IT IS LOANED FOR USE WITH REFERENCE TO VAV GROUP CONTACT WITH OR PERSONNEL LIMITED TO VAV GROUP.

110 BL DRIVE
 ELKHART, IN 46534
 (317) 264-7301
 VAV GROUP
 SJC IND
 11-0028-0
 A