

## INSTALLATION INSTRUCTIONS

### MODEL: 40025 BIKE STORAGE HOIST

**THANK YOU FOR YOUR PURCHASE.** We take a **SATISFACTION GUARANTEED** approach to our products and our business, if you are not satisfied in any way, or if we can provide you with assistance or information, PLEASE call us TOLL FREE at 800-346-7332 or e-mail us at [contactus@mygearup.com](mailto:contactus@mygearup.com).

The GEARUP™ Up & Away Bike Hoist is designed to hold one bicycle, and other items of similar dimensions and weight that can be safely secured using the existing lift hook set up.

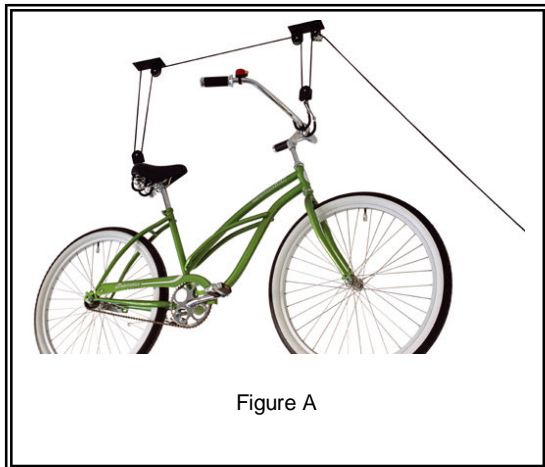

Figure A

#### Bill of Material:

A.	40025C	Hoist Lifting Pulley w/LOC Mechanism	1
B.	40025D	Hoist Pulley	1
C.	40025E	Hoist Lifting Hook Set	2
D.	40025F	Hoist Rope	1
E.	40025G	Hoist Rope Tie Off Cleat	1
F.	40025H	Hoist Phillips Head Screw 2" Silver	6
G.	40025J	Hoist Phillips Head 2" Screw Gold	2

## SAFETY NOTICE

### READ BEFORE INSTALLING AND USE

1. **BEFORE DRILLING & INSTALLING** mounting hardware – **BE SURE NO** electrical, gas, water, or other obstructions will be interfered or damaged. **NOTE:** Drilling into electrical or gas lines can result in serious injury, death, and/or fire. If unsure of the exact location of these obstructions, seek Professional help.
2. **DO NOT INSTALL** over personnel, work areas, and/or walkways.
3. **BEFORE INSTALLING** – **BE SURE** structure where Hoist System is to be attached is **ADEQUATE** enough to support the Hoist and the load(s) to be lifted. If unsure, seek Professional help.
4. **BEFORE LIFTING** – **BE SURE** the item's total weight falls within the stated weight restriction of 50 pounds.
5. **BEFORE LIFTING** – **BE SURE** weight of the load is evenly distributed between both lifting hooks.
6. **BEFORE LIFTING** – **BE SURE** no personnel and/or animals are under or near the load to be lifted.
7. **BEFORE LIFTING** – **BE SURE** the lifting hooks are fully attached to the bicycle as shown in **FIG A**.
8. **BEFORE LIFTING** – perform visual check of the Hoist System ensuring it is firmly attached to the ceiling.
9. **BEFORE LIFTING** – perform visual check of the rope. **DO NOT USE** if the rope shows signs of wear. **REPLACE ROPE** at first sign of wear or at least once annually.
10. **MAXIMUM WEIGHT** capacity is 50 pounds (25 pounds per each lifting hook set).
11. The Bike Hoist is designed for indoor use **ONLY**.

# INSTALLATION INSTRUCTIONS

## STEP ONE – Determine Location

1. Determine location where the Hoist System is to be installed. Remember, check for electrical, gas, water, and/or other items that could be compromised or damaged during the installation.
2. The ceiling area where the Hoist System is to be attached, **MUST BE** a solid structure and capable of holding the Hoist System and the item being lifted.
3. The 2 – Pulleys must not exceed 5 feet in distance from one another.
4. The location selected **MUST PROVIDE** adequate clearance to walls and other obstructions.

## STEP TWO – Determine Type of Installation

The Hoist System can be installed directly to an exposed ceiling joist or to a flat (Finished Ceiling). Please note the 2 examples as shown below. The final determination will be based on the type of ceiling where the Hoist is to be installed. In either case, the hoist **MUST BE** installed in the direction of the ceiling joist.

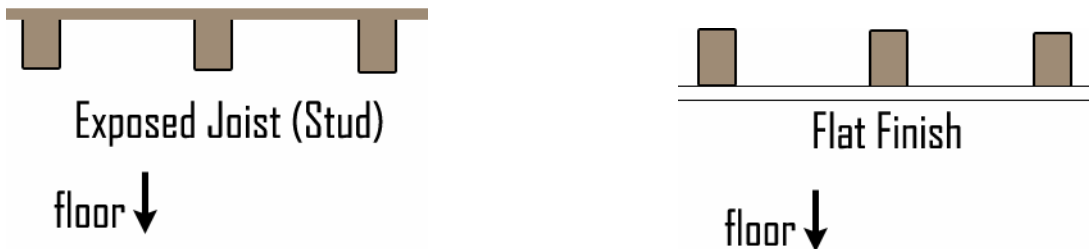

## STEP THREE – Exposed Joist Installation (For Flat Ceilings go to STEP FOUR)

1. Once the location has been determined, position the lifting pulley (40025C) against the joist as shown in the drawing below. Mark the location of the three 7/64" holes for the mounting bolts.
2. Drill the 3 holes just marked using a 7/64" drill bit.
3. Re-position the lifting pulley (40025C) and insert 3 screws (40025H) as shown below under the Flat Ceiling Installation.
4. Position lifting pulley (40025D), not to exceed 5 feet from pulley 40025C, and repeat steps 1-2-3 above.
5. Attach Rope Tie-Off Cleat (40025G) to nearby wall using 2 gold screws (40025J).
6. Before attempting to use the newly installed Hoist System, please closely review all procedures and warnings contained herein.

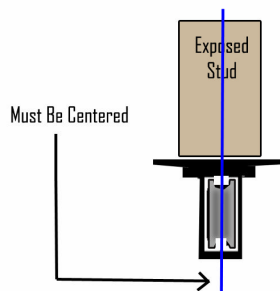

## STEP FOUR – Flat (Finished) Ceiling Installation

1. Once the location has been determined, locate & mark the centerline of the joist where the first lifting pulley will be attached.
2. Position first lifting pulley (40025C), along centerline marked above, and mark the 3 mounting holes. **NOTE:** As shown in the picture below, the mounting screw must go into the center of the joist.
3. Drill three 7/64" pilot holes through the flat ceiling and into the center of the joist.
4. Re-position the lifting pulley and attach using three 2" Screw (40030H). Bracket must be tightly attached to the ceiling.
5. Position second pulley (40035D) and repeat steps 2-3-4 above. **NOTE:** The distance between both brackets must not exceed 5 feet. Both brackets must be in a straight line to one another.
6. Attach rope Tie-Off Cleat to desired wall position using two 2" gold screws (40030J).
7. Before attempting to use the newly installed Bike Hoist, please closely review all procedures and warnings contained herein.

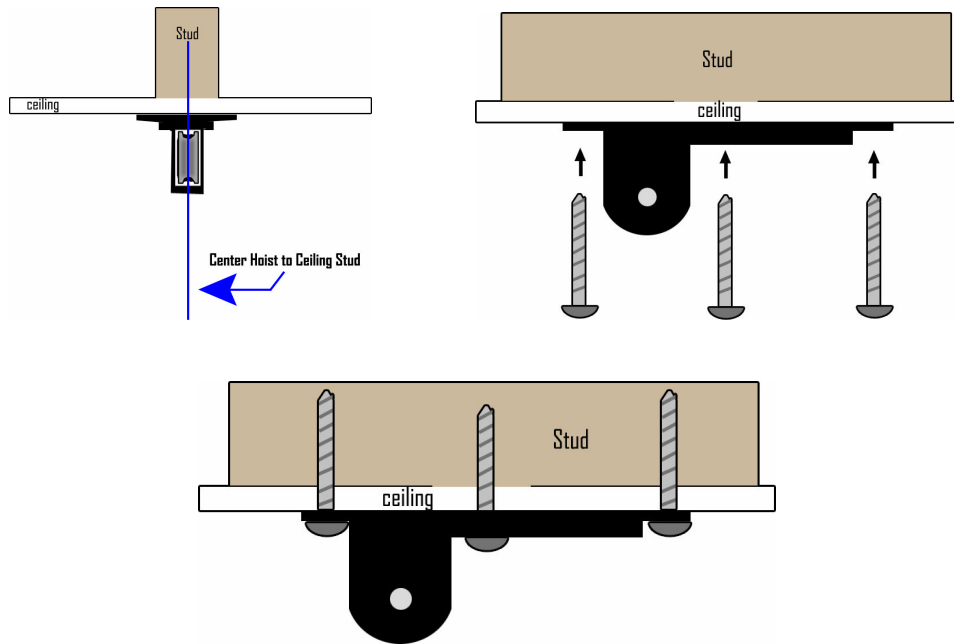

## INSTRUCTIONS FOR USING THE HOIST SYSTEM

### Lifting and Storage

1. **DO NOT** exceed weight limitation of 50 total pounds.
2. **MAKE SURE** no people or pets are under or need the load to be lifted.
3. **UNTIE** rope from the Tie-Off Cleat, and lower the lifting hooks by releasing the rope locking mechanism. To release, pull the rope straight down. Without any weight, you may have to gently pull the hooks downward, keeping the 2 hook sets even to one another.
4. **ATTACH** the lifting hooks to the item to be lifted. **BE SURE** the load is evenly balanced between the 2 hooks, and that the weight is evenly distributed between both hooks.
5. **BE SURE** the lifting hooks are fully attached to the load and that they cannot become separated from the load.
6. **GENTLY** lift the item just above the floor and **STOP**. Re-check the item to ensure the lifting hooks are secure and that the hoist is well attached to the ceiling.
7. **COMPLETE** the lift to the desire position; lock in place by pulling the rope out and up. Securely tie the loose end of the rope to the wall **SAFETY** Tie-Off Cleat.

### Lowering

1. **MAKE SURE** no people, pets, or obstructions are under or near the item being lowered.
2. **BEFORE** undoing the rope from the **SAFETY** Tie-Off Cleat, **BE SURE** the locking mechanism is still engaged and holding the item.
3. **UNTIE** rope from the Tie-Off Cleat.
4. **PULL** the rope downward to release the locking mechanism, while maintaining a firm grip on the rope at all times.
5. **GENTLY** lower the item to the ground. **DO NOT** allow the load to free-fall to the ground.
6. **DETACH** the item, and raise the hooks back to the storage position, lock in place, and tie rope to cleat.

## WARNING

**DO NOT STEP, CLIMB, OR HANG ON THE STORAGE RACK**

**DO NOT ALLOW SMALL CHILDREN OR PETS TO PLAY IN, ON, OR AROUND THE STORAGE RACK. IMPROPER INSTALLATION AND/OR USE OF THE STORAGE RACK COULD CAUSE SERIOUS INJURY AND/OR DEATH.**

User assumes total responsibility for the proper installation and use of this product. GearUp Inc. will not be held liable for damages or injuries resulting from the installation and/or use of this product. If the installer or user is unsure of the requirements described herein, it is his/her responsibility to seek adequate professional assistance or contact our customer care center at 800-346-7332. **REMEMBER** – stored items can fall resulting in injuries and/or property damage when not properly installed or used.

**THANK YOU** again for your purchase. We have worked hard to make sure the product you purchased is of top quality and that all parts and necessary instructions have been included. If we have overlooked anything, or if we can be of assistance, help walk you through installation, or offer tips on how to use our product, **PLEASE** give us a call on our **Toll Free Customer Hotline 800-346-7332**. **YOUR SATISFACTION IS OUR TOP PRIORITY.**

Visit us at our web site [www.mygearup.com](http://www.mygearup.com) for other storage solutions and special offerings.