

Seaport Channelside

1120 East Twigg Street | Tampa, FL 33602

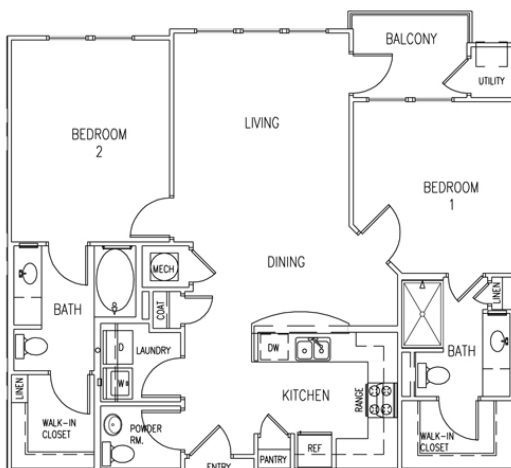

Nika Corporate Housing offers resort style amenities and top-notch upgrades such as granite countertops and stained concrete flooring. Seaport Channelside is also within walking distance to the Trolley, bringing you to Channelside's Bay Plaza, historic Ybor City and Downtown. The Florida Aquarium, St. Pete Times Forum, fine restaurants and other entertainment venues are just minutes away.



1, 2, and 3 bedroom options
Floor plans vary based on availability

Community Features

- Gated/Controlled Access
- Secured Covered Parking
- Resort-Style Swimming Pool
- State-of-Art Fitness Center
- Outdoor patio with Gas Grills
- Resident Lounge and Business Center
- Car Care Center
- Resident Spa
- Billiards Room with Poker Table

Apartment Features

- Granite Countertops
- Stained Concrete Floors
- All Black GE Appliances
- Garden Bathtubs
- Balcony/Patio

Pet Policies

- Pet Friendly Community
- Breed/Weight Restrictions May Apply

Location



Your Place, Your Way

Seaport Channelside

1120 East Twiggs Street | Tampa, FL 33602



Your Place,

Your Way