

ASSEMBLY AND PART DRAWING

IG3000, KGE3000Ti

KIPOR

106 KGE3300Ti-08330
Door lock parts

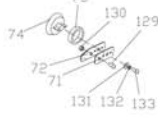

KGE3300Ti-13100
Control panel assembly

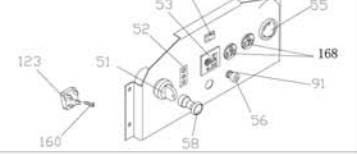

KGE3500Ti-13210
Connecting wire

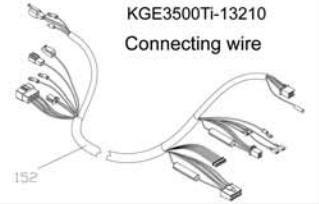

KGE3500Ti-18000
Land wheel assembly

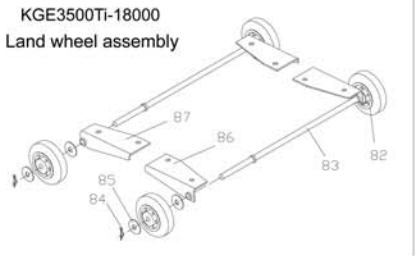

KG160-12000a

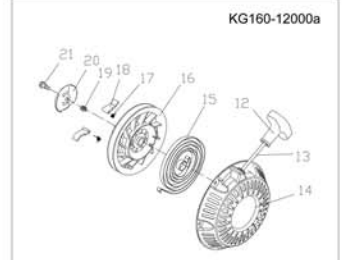

KGE 3300Ti-10500
Complex Heat Insulation Aluminum Foil Assembly

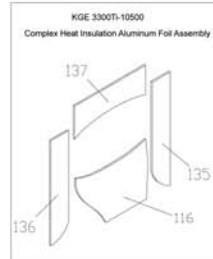

KIPOR IG3000 / KGE3000Ti INVERTER GENERATOR PARTS

No.	Manf. #	Order #	Description	Qty.
1	KG205GETI-00000	66577	Gasoline engine	1
2	KG205GETI-15100	66007	Electric Starter	1
3	KD(M)30(A)-02205		Stator location pin	4
4	KD(M)35(A)-02100		Stator assembly	1
5	KD(M)30(A)-02200		Rotor assembly	1
4-5	KD30-02100/02200	66008	Stator/Rotor assembly	
6	KGE3300TI-05001	66904	Fan	1
7	KG160-05004		Flywheel nut	1
8	KGE3300TI-05001a		Claw disc fixing plate weldment	1
9	KG160-05005a	66929	Starter Wheel	1
10	KGE3300TI-04001	66897	Engine Air Cover	1
11	KG160-12000a	66930	Recoil starter	1
12	KG160-12011		Starter handle	1
13	KG160-12009		Starter guyrope	1
14	KG160-12101		Starter case	1
15	KG160-12003		Recoil starter spring	1
16	KG160-12002a		Starter scroll	1
17	KG240-12007		Pallet spring	2
18	KG240-12008		Pallet	2
19	KG240-12004		Friction spring	1
20	KG240-12005		Friction guide plate	1
21	KG240-12006		Tighten bolt	1
22	KG205GETI-07002	66372	Air filter cover	1
23	KG205GETI-07100	66191	Air Filter Element	1
24	KG205GETI-07001	66373	Air filter base case	1
25	KG160-07007		Carburetor gasket	1
26	KG200GTI-11000		Smart throttle weldment	1
27	KG200GTI-02019	66884	Carburetor washer B	1
28	KG200GTI-10000	66006	Carburetor	1
28A	P19A1-015A	66283	High Altitude Jet	
29	KG160-02018	66183	Carburetor washer A	1
30	KG205GTI-02017a		Carburetor collets	1
31	KG160-02013	66888	Inlet pipe washer	1
32	24BYJ24	66147	Stepping motor	1
33	KG200GTI-10210		Motor frame parts	1
34	KGE3300TI-13300	66446	Ignition coil	1
35	KGE3500TI-13601	66016	Trigger	1
36	KGE3300TI-13320	66892	Ignition coil bracket	1
37	KGE3300TI-01010		Cylinder base cover	1
38	KG160-02014	66182	Exhaust pipe gasket	1
39	KGE3300TI-10301	66259	Muffler elbow	1
40	KGE3300TI-10100	66257	Muffler	1
41	KGE3300TI-10302	66926	Washer A	1
42	KGE3300TI-10210		Muffler cover	1
43	6-FM-9	66285	Battery	1
44	KGE3300TI-17100	66448	Battery strap	1
45	KGE3300TI-11009	66448	Fuel Tank Support	1
46	QC/T620-1999	66496	A type clip 8-12	2
47	KGE3300TI-08200	66250	Handle	2
48	KGE3300TI-08204	66441	Handle rubber sheath	4
49	KGE3300TI-08401	66253	Front cover	1
50	KGE3300TI-13110	66906	Control panel (face plate only)	1
51	JK427A	66908	Ignition Switch with Keys	1
51a	JK427A-1	66909	Ignition Key	
52	DHQ-30	66153	Ignition Module	1
53	WZ-Z2	66284	DC receptacle	1
54	RF-1003-BB2	66498	Smart throttle switch	1
55	L5-30	66279	30A TL Receptacle	1
56	GB/806-1988		Grounding nut	1
57	KGE3300TI-11005	66248	Fuel Switch Lever	1
58	KGE3500TI-14000		Smart throttle grip	1

No.	Manf. #	Order #	Description	Qty.
59	8KM-214-002	66902	Guide Plate Sheath	6
60	DU30	66020	Inverter Module	1
61	8KM-213-002	66903	Module shock pad	3
62	KGE3300TI-08700	66893	Frame Assembly	1
63	GB/T5780-1986		Bolt M6X1	2
64	KGE3300TI-06700		Shock Pad of Chassis Bottom	4
65	KGE3300TI-03000b	66894	Chassis Assembly	1
66	KGE3300TI-12100	66263	Shock Pad	2
67	KGE3300TI-12200	66264	Shock Pad	2
68	KGE3300TI-08601		Exhaust Panel	1
69	KGE3300TI-08501	66254	Rear Cover	1
70	KGE3300TI-11001	66370	Fuel Tank	1
71	5GF-LDE-05021		Strengthen Plate of Door Lock	1
72	5GF-LDE-05022		Door Lock	1
73	KGE3300TI-08304a		Door Lock Gasket	1
74	KGE3300TI-08303a		Door Lock Button	1
75	KGE3300TI-08310	66251	Service Door	1
76	KGE3300TI-08108	66440	Fuel Tank Sheath	1
77	KGE3300TI-08110	66866	Top Cover	1
78	KGE3300TI-11010	66444	Gas Cap	1
79	KGE3300TI-08106	66438	Fuel Gauge Grommet	1
80	KGE3300TI-11300	66243	Fuel Gauge	1
81	KGE3300TI-11003		Fuel Tank Spring Washer	4
82	KGE3500TI-18001	66268	Wheel	4
83	KGE3300TI-18100	67223	Axle Weldment	2
84	QC/T623-1999	66496	Wheel Clip	4
85	GB96-85	66406	Wheel Washer 12	8
86	KGE3500TI-18200	67224	Right Supporting Plate Subassembly	2
87	KGE3500TI-18300	67225	Left Supporting Plate Subassembly	2
88	GB/T5789-1986		Bolt M6X12	26
89	GB/T5789-1986		Bolt M6X10	7
90	GB/T845-1985		Self-tapping Screw ST-4.8X18	6
91	GB/T5789-1986		Bolt M6X25	20
92	GB/T5789-1986		Bolt M6X20	10
93	GB/T70.1-2000		Inner Hexagonal Bolt M8X20	4
94	GB/T5789-1986		Bolt M8X60	2
95	KD(M)30(A)-02206		Stator Location Pin	4
96	KGE3300TI-13510		Module Connection Plate	1
97	KGE3300TI-01020		Air Conduct Plate	1
98	KGE3300TI-01030		Cylinder Head Air Conduct Plate	1
99	KGE3300TI-03003	66437	Bottom Tray Plug	1
100	KGE3300TI-03100		Shock Pad Pressing Plate Weldment	1
101	KGE3300TI-03200		Shock Pad Pressing Plate Weldment	1
102	KDE5000X-30003		Shock Pad	2
103	KGE3300TI-08104		Handling Panel Cover	1
104	KGE3300TI-08107	66439	Sight Glass	1
105	KGE3300TI-08320		Door Frame	1
106	KGE3300TI-08330	66442	Door Latch Kit	1
107	KGE3300TI-08602		Seal Strip of Exhaust Window	1
108	KGE3300TI-08709		Connection Curved Plate	1
109	KGE3300TI-08716		Machine Frame Pad	2
110	KGE3300TI-08801a		Inner Labeled Sponge of Machine Cabinet Left Side Plate	1
111	KGE3300TI-08802a		Inner Labeled Sponge of Machine Cabinet Door Plate	1
112	KGE3300TI-08803a		Inner Labeled Sponge of Machine Cabinet Upper Cover Plate	1
113	KGE3300TI-08804a		Inner Labeled Sponge of Front Cover	1
114	KGE3300TI-08805a		Inner Labeled Sponge of Rear Cover	1
115	KGE3300TI-08808a		Inner Labeled Sponge of Front and Rear Cover	6
116	KGE3300TI-10501		Complex Heat Insulation Alumunim Foil	1

KIPOR IG3000 / KGE3000Ti INVERTER GENERATOR PARTS

No.	Manf. #	Order #	Description	Qty.
117	KGE3300TI-10400	66242	Spark Arrestor	1
118	KGE3300TI-11004		Fuel Tank Spring Washer Sleeve	4
119	KGE3300TI-11007	66937	Fuel Supply Pipe	1
120	KGE3300TI-11008	66262	Fuel Filter Strainer	1
121	KGE3300TI-11009		Screw	1
122	KGE3300TI-11400	66445	Fuel Valve	1
123	KBPC25A 1000V	66517	Rectifier	1
124	SFCD9AH	66941	Charging Regulator	1
125	GY6	66407	Starting Relay	1
126	KGE3300TI-13002		Centra Line Seal Ring	1
127	GB/T93-1987		Spring Washer 8	12
128	GB/T97.1-2002		Flat Washer 6	13
129	GB/T818-2000		Screw M5X8	1
130	GB/T6170-2000		Nut M5	1
131	GB/T97.1-1985		Flat Washer 5 (Blackening)	1
132	GB/T93-1987		Spring Washer 5 (Blackening)	1
133	GB/T818-2000		Screw M5X12 (Blackening)	3
134	GB/T818-2000		Screw M6X10	4
135	KGE3300TI-10502		Complex Heat Insulation Aluminum Foil	1
136	KGE3300TI-10503		compounding heat insulation aluminum platinum (3)	1
137	KGE3300TI-10504		compounding heat insulation aluminum platinum (4)	1
138	GB/T5789-1986		Bolt M8X16	8
139	KGE3500TI-13110	66906	Control panel	1
140	GB/T6177.1-2000		Flange face nut M8	4
141	GB/T6170-2000		Nut M8	4
143	GB/T97.1-1985		Plain washer 8	4
144	GB/T5789-1986		Bolt M6X16	2
145	GB/T818-2000		Screw M6X15	2
146	GB/T93-1987		Spring washer 8	4
147	AWG10		Battery connection (-)	1
148	AWG10		Battery connection (+)	1
149	KGE3300TI-11410		Oil switch long filtering net	1
150	GB/T5789-1986		Bolt M6X22	10
151	KG205GETI-03001	66196	Breather Pipe	1
152	KGE3500TI-13210	66267	Wiring Harness	1
153	P15-028		Fork	1
154	P15-029		Fork spring	1
155	GB/T818-2000		Screw M6X15	2
156	GB/T5789-1986		Bolt M6X25	2
157	GB/T6177.1-2000		Flange face nut M6	2
158	GB70-1985		Battery connecting sheath M6X60	4
159	KGE3300TI-17004		Battery connecting sheath (black)	1
160	GB/T818-2000		Screw M5X20	1
161	GB/T5789-1986		Bolt M6X18	6
162	GB/T818-2000		Screw M3X8	2
163	GB/T818-2000		Screw M4X10	2
164	GB/T818-2000		Screw M4X8	2
165	KGE330011-17004		Battery connecting sheath (black)	1
166	GB/T5789-1986		Bolt M6X70	1
167	GB/T6170-1986		Nut M6	2
168	5-20R	66763	20A Receptacle	2