

PH3100Ri Powerhouse Inverter Generator

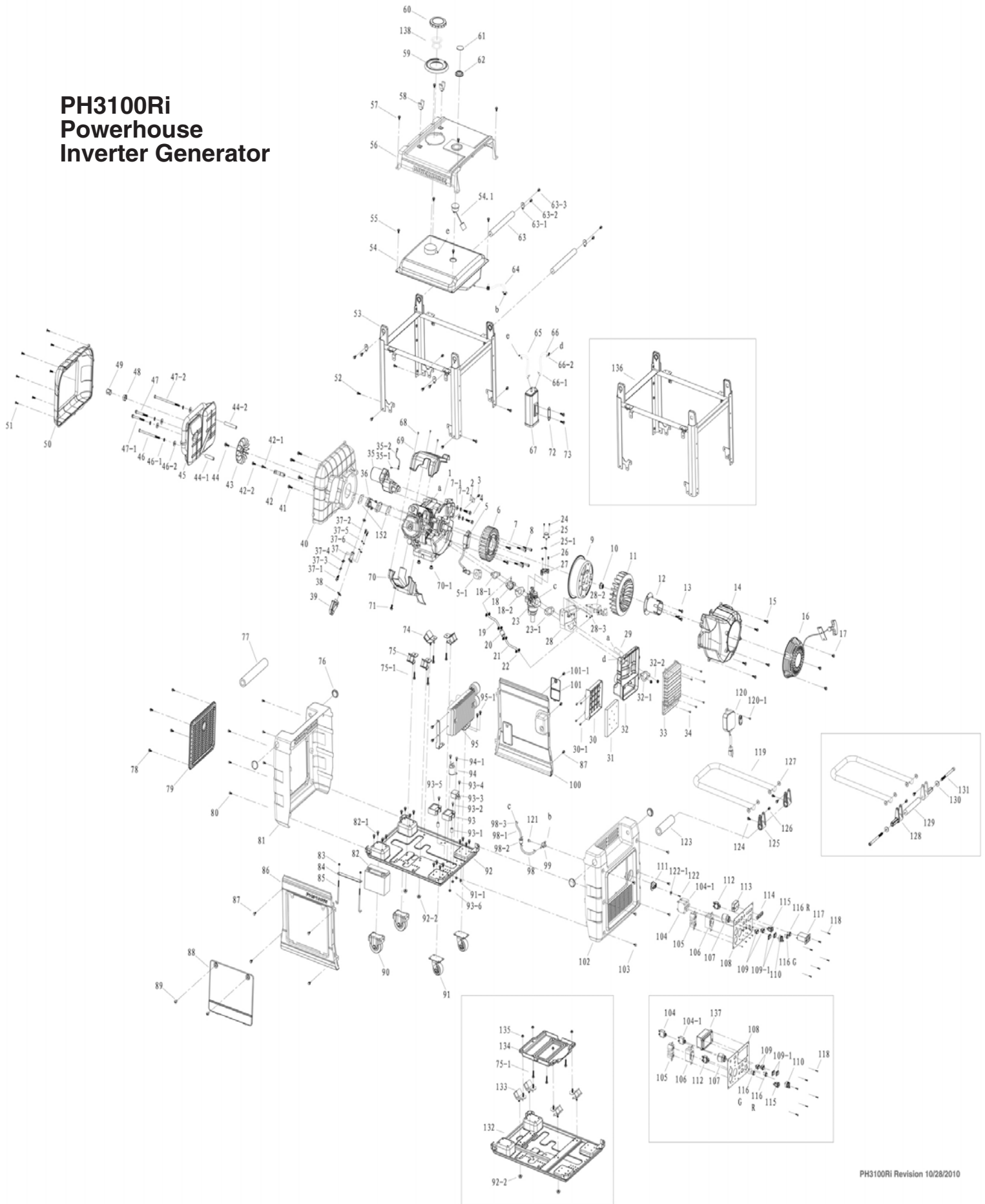

PH3100Ri Revision 10/28/2010

Powerhouse Inverter Generator PH3100Ri

No.	Description	Manf. #	Order #
1	Engine Assembly	7504	69449
2	Cable holder	09080104	69500
3	M6 X 12 flange bolt	03050221	69350
4	M6 X 25 flange bolt	03050241	69349
5	Ignition Coil	09080012	69456
5-1*	Ignition coil sheath sponge	09080019	
6	Stator assembly	60027	69304
7	M8 X 40 flange bolt	03050229	69354
7-1*	M8 lock washers	3030222	
7-2*	M8 Flat washer	03030143	
8	M6 X 55 hexagon screw	03051036	69372
8-1*	M4 Flat washer	03030124	
9	Rotor Assembly	61015	69306
10	M16 nut	03060206	69376
11	Main fan	09080006	69451
12	Starter cup	09080009	69454
13	M6 X 16 hexagon screw	03050360	69367
14	Fan cover	09080007	69452
15	M6 x 20 flange bolt	03050223	69352
16	Recoil Starter Assembly	09080008	69453
17	M6 x 12 flange bolt	03050221	69350
18	Carburetor gasket, plastic	09080013	69546
18-1	Carburetor Gasket 1	09080015	69572
18-2	Carburetor Gasket 2	09080018	69573
19	Pipe connecting carburetor, gasket plastic	09080162	69596
20	Backpressure Valve	09080118	69303
21	Connection hose, choke	04080301	69383
22	Steel Wire Clip	7524	69300
23	Carburetor	09080192	69458
23-1	Carburetor Gasket 3	09080021	69574
24	M3 X 8 round head bolt	03050153	69345
24-1*	M4 lock washers	03030115	
25	Step motor	09020117	69414
25-1	Throttle fork	09020120	69830
25-2*	Throttle fork spring	03070147	69415
26	M4 X 11 round head bolt	03050815	69575
27	Step motor, base	09080016	69459
28	Auto choke components Assembly	09080011	69455
28-1	Carburetor Gasket 3	09080021	69574
28-2	Electric choke thermister	12015	69887
28-3	M3 X 10screw	03050804	
28-4*	Choke spring	03080154	
29	Breather pipe	09080153	69514
30	Air Cleaner cartridge	09080028	69464
30-1	ST3.5 X 12 self-tapping screw	03050316	69359
31	Air filter element, 3100 and 5200G	09080025	69461
32	Air Cleaner case	09080024	69460
32-1	Air Cleaner case Plate	09080026	
32-2	M6 nut	03060133	69623
32-3*	Air filter case	09090067	69580
32-4*	M5 nut	03060120	69374
33	Air Cleaner Cover	09080027	69463
34	ST 3.5 X 12 self-tapping screw	03050316	69359
35	Starting motor	09080033	69338
35-1*	M4 X 8 screw	03050825	69343
36.	Exhaust pipe	09080036	69469
36-1	Exhaust pipe gasket	09080040	69472
37	Pipe connecting fill valve	09080148	69510
37-1	M5 x16 bolt	03050356	69581
37-2	M6 x16 bolt	03050360	69367
37-3*	M5 lock washer	03030116	

No.	Description	Manf. #	Order #
37-4*	M5 Flat washer	03030121	
37-5*	M6 lock washer	03030228	
37-6*	M6 Flat washer	03030124	
38	SAC valve gasket	09080140	69508
39	SAC Valve	09080139	69507
40	Muffler cover	09080038	69470
41	Muffler cover holder	09080041	69473
42	M6 nut	03060133	69623
42-1	M6 X 12 flange bolt	03050221	69350
42-2	M6 X 16 flange bolt	03050222	69351
43	Fan	76071	69331
44	M8 X 16 hexagon screw	03050140	69594
44-1	Muffler sleeve (short)	03070148	69583
44-2	Muffler sleeve (L)	03070149	69584
45	Muffler	09080143	69509
46	M8 X 165 bolt	03050239	69358
46-1*	M8 lock washer	03030227	
46-2*	M8 Flat washer	03030138	
47	M8 X 85 bolt	03050237	69357
47-1	M8 X 100 bolt	03051040	69833
47-2	M8 X 170 bolt	03051054	69834
47-3*	M8 lock washer	03030227	
47-4*	M8 Flat washer	03030138	
47-5*	M8 lock washer	03030227	
47-6*	M8 Flat washer	03030138	
47-7*	M8 lock washer	03030227	
47-8*	M8 Flat washer	03030138	
48	Clamp	09080193	69585
49	Spark arrestor	09080194	69586
50	Muffler Cover case	09080039	69471
51	M6 X 16 flange bolt	03050222	69351
52	M6 X 12 flange bolt	03050221	69350
53	Frame	09080070	69489
54	Fuel tank	09080023	69477
54-1	Fuel level indicator	09080116	69504
55	M6 X 16 flange bolt	03050222	69351
59	Fuel tank sleeve	09080057	69478
60	Fuel cap	09080113	69501
61	Sight glass cover	09080060	69481
62	Sight glass grommet	09080059	69480
56	Top cover	68583	69325
57	M6 X 16 flange bolt	03050222	69351
58	Fix clip for the Fold over handle	09080066	69488
63	Handle bar	09080178	69506
63-1	Handle Clamp	09080179	69587
63-2	M6 X 30 flange bolt	03050230	69588
63-3	M6x18 Cross outside the Hexagon bolt	03050224	69589
64	Fuel hose, gas tank	04180305	69387
65	Carbon canister hose	09020222	69419
66	Carbon canister hose	09020222	69419
67	Carbon canister	09080137	69593
68	M3.5 x 12 self-tapping screw	03050316	69359
69	Top engine cover	09080031	69466
70	Bottom engine cover	09080032	69467
70-1	M8 nut	03060208	69838
71	M8 X 16 flange bolt	03050140	69594
72	Carbon tank bracket	09080190	69595
73	M6 X 12 flange bolt	03050221	69350
74	3600 damping feet	09080043	69475
75	Vibration dampener	09010395	69394
75-1	M8 X 40 flange bolt	03050229	69354

Powerhouse Inverter Generator PH3100Ri

No.	Description	Manf. #	Order #
76	Rubber handle plugs	09080058	69479
77	Handle sponge sleeve (L)	09080094	69497
78	M6 x12 flange bolt	03050221	69350
79	Exhaust cover	68582	69324
80	M6 x16 flange bolt	03050222	69351
81	Rear housing	68581	69323
82	Battery	09080063	69484
82-1	M6 X 12 flange bolt	03050221	69350
83	M5 nut	03060207	69826
84	Fix press plate for battery	09080115	69502
85	Fix bolt for battery	09090073	69516
86	Left side cover	09080075	69490
87	M6 X 12 flange bolt	03050221	69350
88	Maintenance cover	09080078	69492
89	M6 X 16 big head bolt	03050713	69370
90	Brake wheel	09080061	69482
91	Swivel wheel	09080195	69483
92	Chassis	09080044	69476
92-1	M5 nut	03060207	69826
92-2	M8 nut	03060208	69838
93	Voltage regulator	901017	69339
93-1	Regulators sleeve	03070136	
93-2	M6 X 30 flange bolt	03050230	69588
93-3	BFP controller	916004	69557
93-4	M5 X 16 flange bolt	03050201	69346
93-5*	M6 nut	03060102	69836
93-6*	M5 nut	03060207	69826
94	Relay	09080098	69498
94-1	M5 X 12 flange bolt	03050339	69347
95	Inverter assembly	71014	69326
95-1	M5 X 8 flange bolt	03050206	69816
98	Pipe connecting carburetor	09080162	69596
98-1	Tubing	09020234	69597
98-2	Fuel filter	09010157	69407
99	Fuel valve	09020116	69413
100	Right side cover	09080076	69491
101	Oil access cover	09080079	69493
101-1	M6 X 12 flange bolt	03050221	69350
102	Front cover	68580	69322
103	M6 X 16 flange bolt	03050205	69599
104	AC circuit breaker 30A	10010115	69528
104-1	AC current breaker 20A	10010109	69527
105	120V-20 amp duplex 5-20	04130124	69381
106	120V-30 amp L5-30	04130125	69382
107	Ignition switch with keys	09080093	69496
108	Metal panel only	04120220	69380
109	Rocker switch	10030101	69529
109-1	Rocker switch cover	10030103	69531
110	Ignition keys, 2	09080089	69442
111	Fuel valve knob	09071015	69443
112	DC circuit breaker	10010102	69526
113	Indicator module	71035	69327
114	Indicator lamps cover	09071016	69444
115	DC output socket	04050135	69377
116R	Stop button (RED)	09080090	69494
116G	Reset button (GREEN)	10030104	69532
116-1*	Button guard	68249	69652
117	Hour meter	09080065	69487
118	M4 X 13 self-tapping screw	03050317	69600
119	Fold over handle	09080184	69511
120	Remote controller assembly	09070403	69439

No.	Description	Manf. #	Order #
120-1*	M4 X 13 self-tapping screw	03050317	69600
121	M5 X 16 bolt	03050201	69346
122	M4 X 16 Round phillips screw	03050128	69602
122-1*	M4 X 10mm) flat washer	03030141	69603
123	Handle Sponge jacket (short)	09080094	69497
124	M6 X 16 flange bolt	03050222	69351
125	Rod bracket	76216	69604
126	M6 X 35 Hexagon bolt	03050366	69605
127	Plastic washer M6 X 15 X 1mm	68544	69606
128	Handle bracket (Starting with bar code number 100317377059001)	76216	69604
129	Threaded handle (Starting with bar code number 100317377059001)	09080199	
130	Washer, 25 x 10 x 2mm (Starting with bar code number 100317377059001)	03030173	
131	Bolt, M10 x 120 (Starting with bar code number 100317377059001)	03051059	
132	Chassis, (Starting with bar code number 100317377059001)	09080177	
133	Vibration dampener (Starting with bar code number 100317377059001)	09080043	69475
134	Engine bracket (Starting with bar code number 100317377059001)	09080070	69489
135	M10 Nut	03060204	
136	Engine Mounting Bracket	09080042	69474
138	Fuel strainer	09080136	60556

ACCESSORIES

No.	Description	Manf. #	Order #
N/S	Oil jug	09060214	69724
N/S	Screwdriver	09060220	69728
N/S	Spark plug socket	09080108	69723
N/S	Battery charge cables	09060221	69726
N/S	Oil drain pipe	09080126	69730
N/S	Powerhouse lettering, one side	68584	69740
N/S	Decals	09050135	69744
N/S	Owners manual	09050118	69736
N/S	High altitude jet	03071405	69665

N/S or * are not shown in exploded view