

**TOWN OF SILT
ORDINANCE NO. 5
SERIES OF 2021**

AN ORDINANCE ANNEXING TO THE TOWN OF SILT, COLORADO AN APPROXIMATELY TWO-ACRE TRACT OF LAND LOCATED NORTH OF GRAND AVENUE AND EAST OF KIM DRIVE, SILT, COLORADO, LOCATED IN UNINCORPORATED GARFIELD COUNTY

WHEREAS, the Town of Silt ("Town") desires to annex to the Town pursuant to section 31-12-106(1), C.R.S. a tract of land known as 0 County Road 218, Silt, Colorado 81652 and described on Exhibit A attached hereto; and

WHEREAS, the Board of Trustees, by Ordinance No. 7, Series of 2001, annexed to the Town certain property known as the MAG, LLC (also known as 1990 Grand PUD), which is adjacent to the 0 County Road 218 property; and

WHEREAS, the Board of Trustees, by Ordinance No. 17, Series of 2012, annexed to the Town certain property known as the Camario Phase II Annexation, which is adjacent to the 0 County Road 218 property; and

WHEREAS, the Board of Trustees has determined that (1) the property known as 0 County Road 218 is entirely contained within the boundaries of a municipality and has been so surrounded for a period of not less than three years; (2) the conditions necessary for the annexation of an enclave under section 31-12-106(1), C.R.S. have been met with regard to the property; and (3) that none of the limitations in section 31-12-106(1.1), C.R.S. prevent the Town from annexing this property; and (4) an annexation impact report is not required under 31-12-108.5 C.R.S.; and

WHEREAS, in order to encourage well-ordered development to the Town of Silt, it is desirable that the 0 County Road 218 enclave be annexed into the Town of Silt; and

NOW THEREFORE, BE IT ORDAINED BY THE BOARD OF TRUSTEES OF THE TOWN OF SILT, COLORADO, THAT:

Section I. That the annexation to the Town of the Annexation Property be and is hereby approved and said real property as described in Exhibit A attached hereto is hereby annexed to the Town and shall be known as "0 County Road 218 Enclave."

Section II. As required by statute, the Town of Silt shall:

- (a) File one copy of the annexation map with the original of this Annexation Ordinance in the office of the Town Clerk of the Town of Silt, Colorado; and
- (b) File for recording and distribution to the relevant state agencies three certified copies of this Ordinance and map of the area annexed containing a legal description of such area with the Garfield County Clerk and Recorder.

INTRODUCED, READ, AND APPROVED ON FIRST READING UPON A PUBLIC HEARING this 13th day of December 2021.

APPROVED ON SECOND READING this 10th day of January 2022.

PASSED, APPROVED ON SECOND READING, ADOPTED AND ORDERED PUBLISHED FOLLOWING A PUBLIC HEARING, this 10th day of January 2022.

TOWN OF SILT

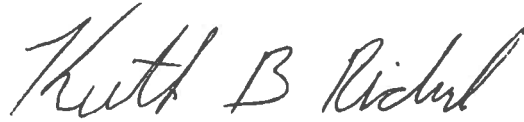

Mayor Keith B. Richel

ATTEST:

Town Clerk Sheila M. McIntyre

EXHIBIT A

Legal Description:

A TRACT OF LAND SITUATED IN THE SW1/4SW1/4 OF SECTION 2, TOWNSHIP 6 SOUTH, RANGE 92 WEST OF THE SIXTH PRINCIPAL MERIDIAN, LYING NORTHERLY OF COUNTY ROAD AS CONSTRUCTED AND IN PLACE AND SOUTHERLY OF THE WARE & HINES DITCH AS CONSTRUCTED AND IN PLACE, SAID TRACT BEING MORE PARTICULARLY DESCRIBED AS FOLLOWS:

BEGINNING AT A POINT ON THE NORTHERLY RIGHT OF WAY LINE OF SAID ROAD, WHENCE THE RE-ESTABLISHED SECTION CORNER COMMON TO SECTIONS 2, 3, 10 AND 11 IN SAID TOWNSHIP AND RANGE BEARS:

SOUTH 87° 56'45" WEST 96.33 FEET;

THENCE NORTH 773.55 FEET;

THENCE SOUTH 80° 08'13" EAST 116.16 FEET;

THENCE SOUTH 751.69 FEET TO A POINT ON THE NORTHERLY RIGHT OF WAY LINE OF SAID ROAD;

THENCE SOUTH 89° 01'00" WEST 114.46 FEET ALONG THE NORTHERLY RIGHT OF WAY LINE OF SAID ROAD TO THE POINT OF BEGINNING:

EXCEPT ANY PORTION OF THE ABOVE DESCRIBED PROPERTY, IF ANY, LYING WITHIN FLYING EAGLE SUBDIVISION.

COUNTY OF GARFIELD
STATE OF COLORADO

ANNEXATION MAP
North of Grand Avenue and East
of Kim Drive Enclave Annexation
 A TRACT OF LAND SITUATED IN THE SOUTHWEST ONE-QUARTER OF THE

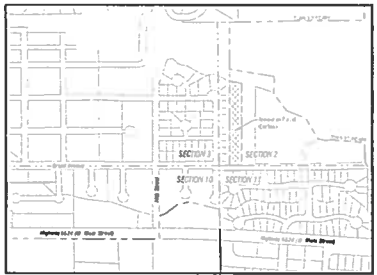

SECTION	OWNER	ACRES	REMARKS
10
11
12
13

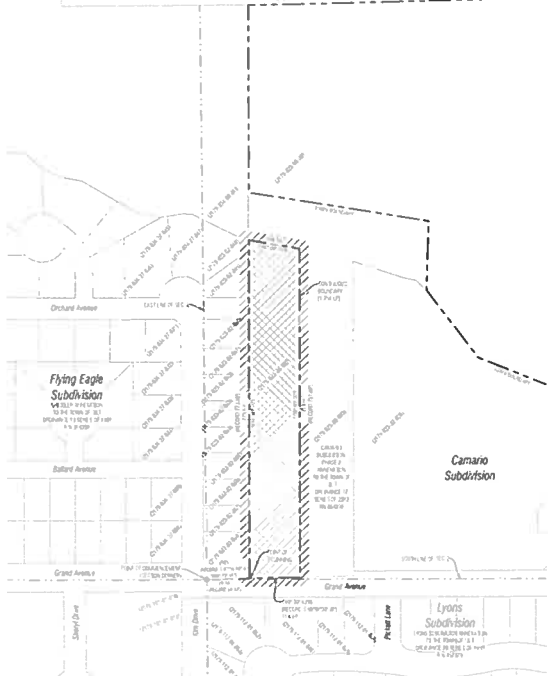

SECTION 10
 1. I, JAMES L. ...
 2. I, ...
SECTION 11
 1. I, ...
 2. I, ...
SECTION 12
 1. I, ...
 2. I, ...
SECTION 13
 1. I, ...
 2. I, ...

811
 Call before you dig
 NORTH
ANNEXATION MAP
 North of Grand Avenue and East of Kim Drive Enclave Annexation
 TO THE TOWN OF SIFT
 1