

# Blue Bowl Instructions

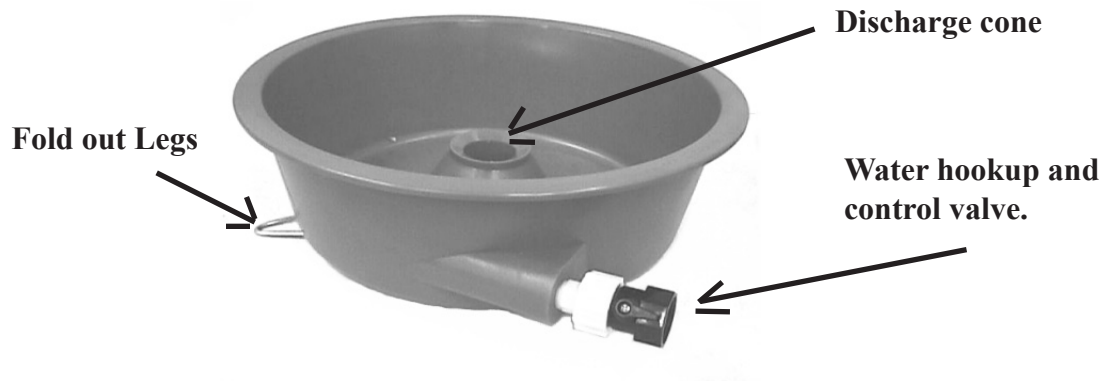

A few minutes spent reading these instructions can produce amazing results.

The recovery unit must be kept clean and free of any oily substances. Wash the interior surfaces with a mild detergent remove any oils. This should be repeated periodically to ensure the bowl surfaces stay clean and oil free.

The recovery unit can be used at home with a simple garden hose connection, however, air bubbles in municipal water supplies may cause the loss of some 100 mesh gold particles. Air bubbles clinging to the sides or bottom of the unit will slow down the separation process. You will get better results by rigging up a 12 volt recirculating pump to recirculate water in a closed end system.

The unit is designed to sit on top of a 5 gallon plastic bucket which serves to catch the tailings. The folding legs should be folded out and used to set the unit on top of a 5 gallon bucket. Hook your garden hose or 12 volt recirculating pump discharge to the unit at the hose connection. Open the water valve slowly. When the water reaches the rim of the bowl, adjust the flow to prevent overflow. Level the unit so water discharges evenly over the center cone.

Carefully prescreen concentrates to at least 30 mesh before adding them to the bowl. Add small amounts of concentrates near the outer rim. Avoid excessive buildup around the base of the cone.

For recovery of micro-fines use a 50 or 100 mesh sieve and start with a low water level. Increase the water level slowly until waste discharges over the center cone. Adjust the control valve to maintain a constant water level.

Concentrates, especially finer mesh, should never be added dry. Pre wet the concentrates and add a few drops of wetting agent to break up surface tension and prevent material from floating causing a loss of micro fines.



The Blue Bowl hooked up to a dredge pump side outlet.