

DRAWN BY: MAM
DATE: 11-13-06

REVISIONS

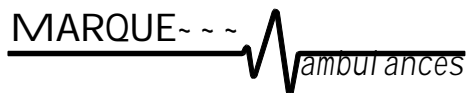

DRAWING TITLE: STREETSIDE INTERIOR VIEW - 68" H.R.
MODEL/TYPE/CHASSIS: TYPE 1 - 144 CADET
DEALER / CUSTOMER: REV/ TACOM
UNIT NUMBER: 4285-96 **PRINT NUMBER:** T1-144CADT-008

Drawing is representative only - Dimensions shown are approximate and may vary from the completed vehicle DO NOT scale this drawing!

FERNO 520 DOUBLE BRACKETS INSTALLED?

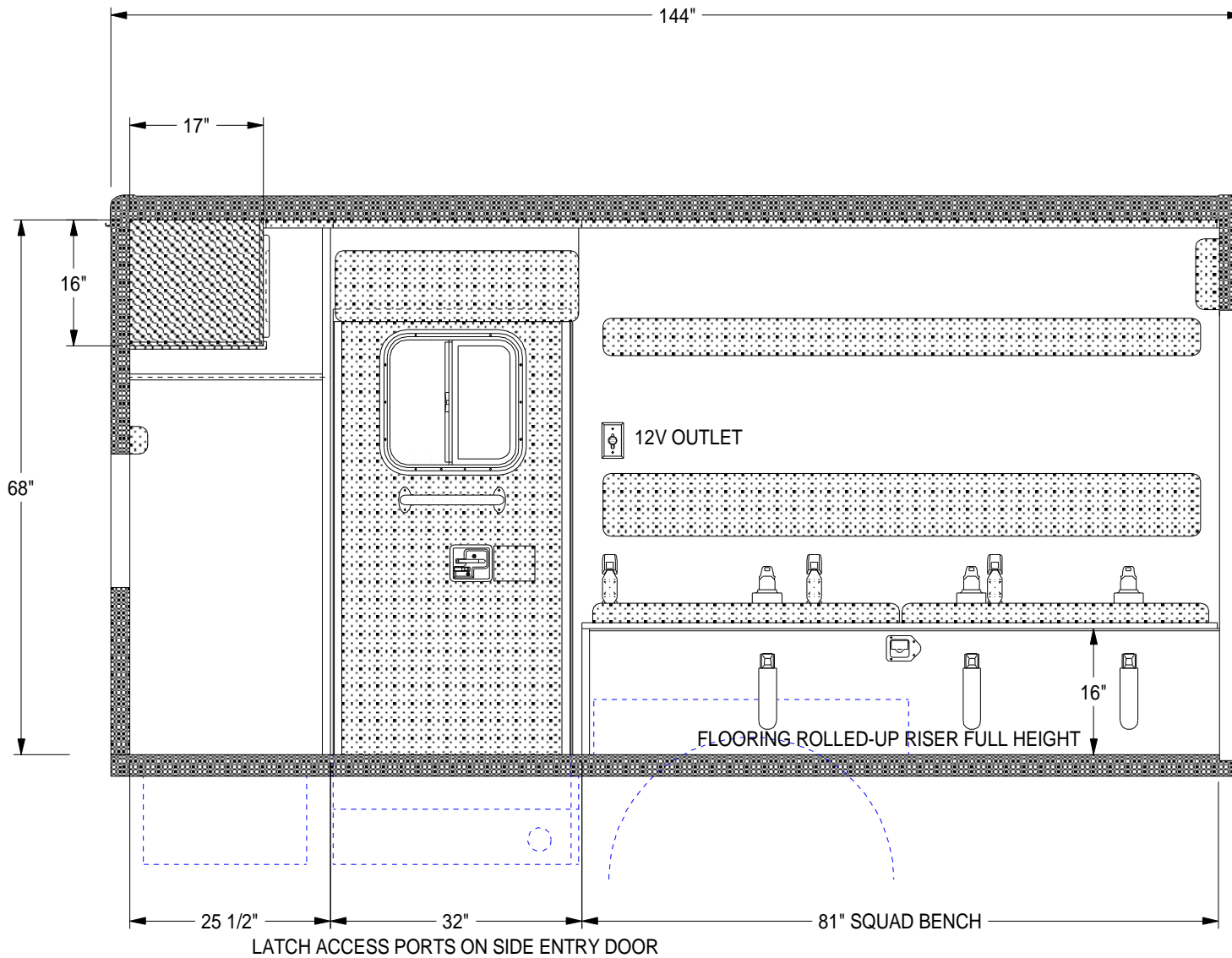

DRAWN BY: Initials
DATE: 01-01-06

Drawing is representative only - Dimensions shown are approximate and may vary from the completed vehicle DO NOT scale this drawing!

REVISIONS

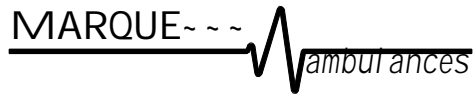

DRAWING TITLE: CURBSIDE INTERIOR VIEW - 68" H.R.
MODEL/TYPE/CHASSIS: TYPE 1 - 144 CADET
DEALER / CUSTOMER: DEALER/CUSTOMER NAME
UNIT NUMBER: ### **PRINT NUMBER:** T1-144CADT-007

LATCH ACCESS PORTS ON REAR ENTRY DOOR

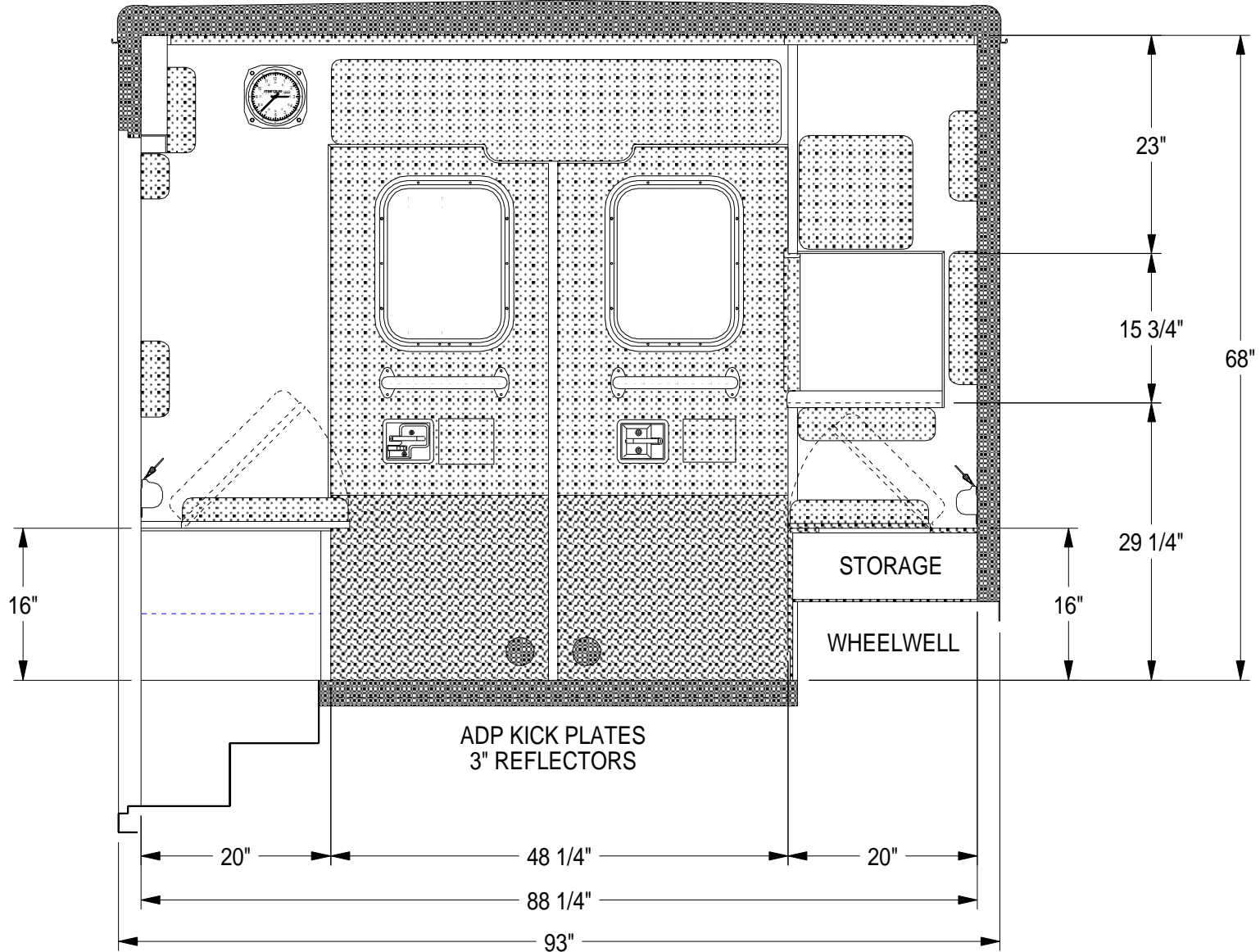

DRAWN BY: MAM
DATE: 11-13-06
Drawing is representative only - Dimensions shown are approximate and may vary from the completed vehicle DO NOT scale this drawing!

REVISIONS



DRAWING TITLE:	REAR INTERIOR VIEW - 68" H.R.
MODEL/TYPE/CHASSIS:	TYPE I - 144 CADET
DEALER / CUSTOMER:	REV/ TACOM
UNIT NUMBER:	4285-96
PRINT NUMBER:	T1-144CADT-006

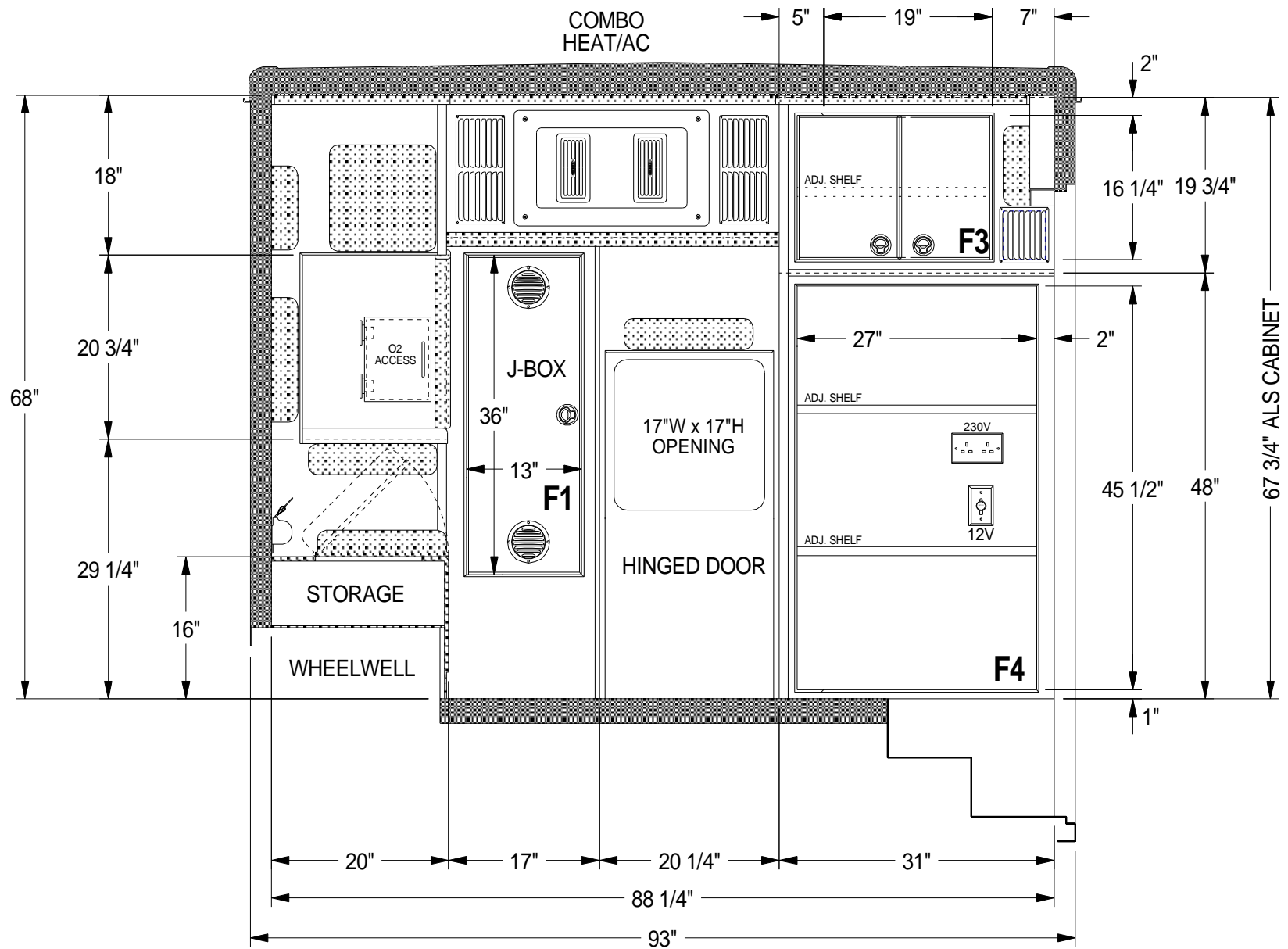

DRAWN BY: MAM
DATE: 11-13-06

REVISIONS

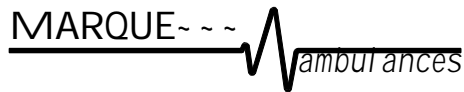

DRAWING TITLE: FRONT INTERIOR VIEW - 68" H.R.
MODEL/TYPE/CHASSIS: TYPE 1 - 144 CADET
DEALER / CUSTOMER: REV/ TACOM
UNIT NUMBER: 4285-96 **PRINT NUMBER:** T1-144CADT-005

Drawing is representative only - Dimensions shown are approximate and may vary from the completed vehicle DO NOT scale this drawing!

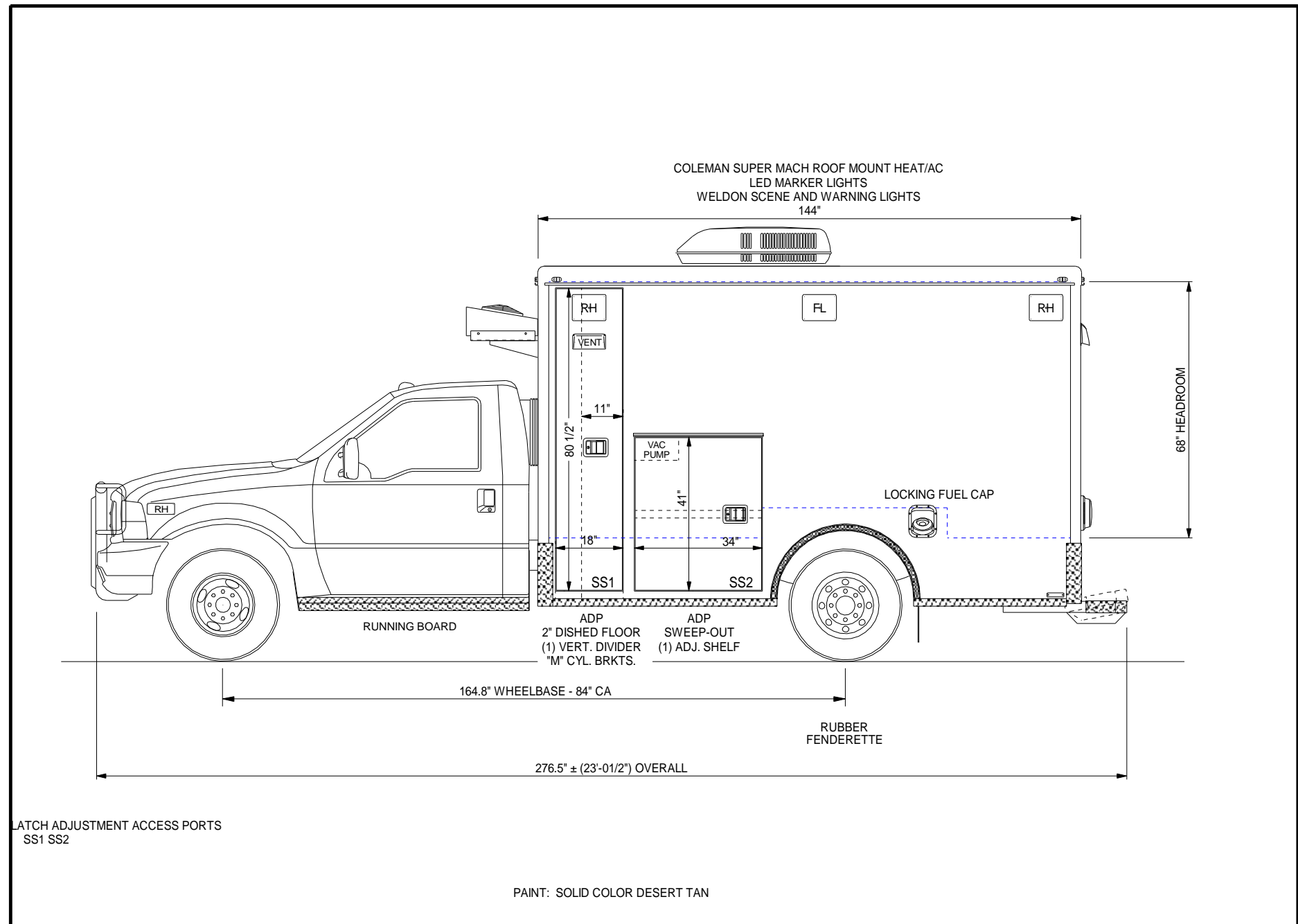

DRAWN BY: MAM
DATE: 11-13-06

REVISIONS

MARQUE ~ ~ ~
ambulances

DRAWING TITLE: STREETSIDE EXTERIOR VIEW - 68" H.R.
TYPE/MODEL/CHASSIS: TYPE 1 - 144 CADET - FORD F350
DEALER / CUSTOMER: REV/ TACOM
UNIT NUMBER: 4285-96 PRINT NUMBER: T1-144CADT-004

Drawing is representative only - Dimensions shown are approximate and may vary from the completed vehicle DO NOT scale this drawing!

COLEMAN SUPER MACH ROOF MOUNT HEAT/AC
 LED MARKER LIGHTS
 WELDON SCENE AND WARNING LIGHTS

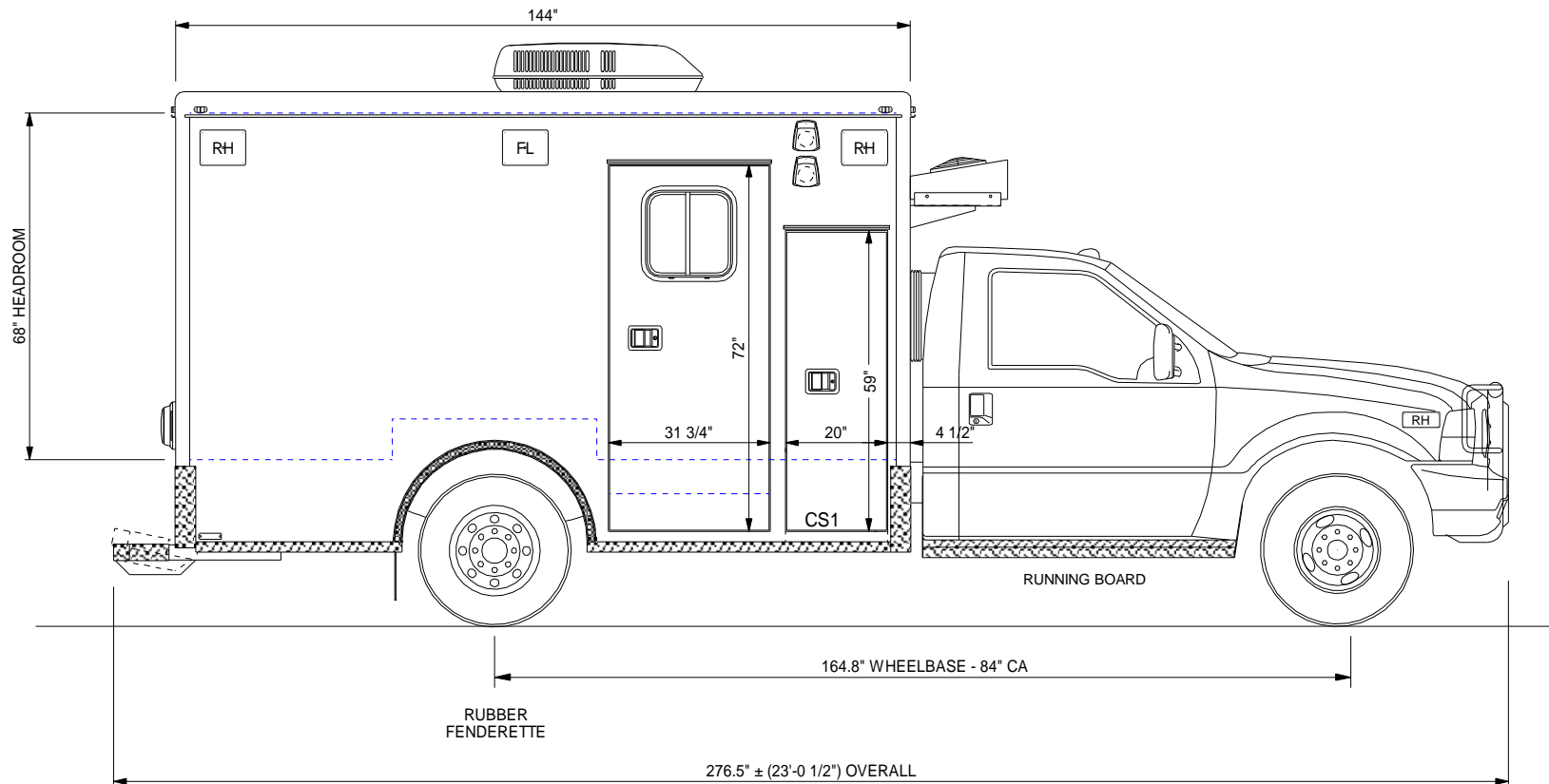

LATCH ADJUSTMENT ACCESS PORTS
 CS1

DRAWN BY: MAM
DATE: 11-13-06

REVISIONS

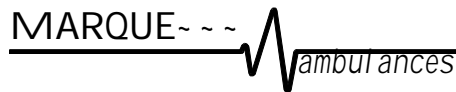

DRAWING TITLE: CURBSIDE EXTERIOR VIEW - 68" H.R.
TYPE/MODEL/CHASSIS: TYPE I - 144 CADET - FORD F350
DEALER / CUSTOMER: REV/ TACOM
UNIT NUMBER: 4285-96 **PRINT NUMBER:** T1-144CADT-003

Drawing is representative only - Dimensions shown are approximate and may vary from the completed vehicle. DO NOT scale this drawing!

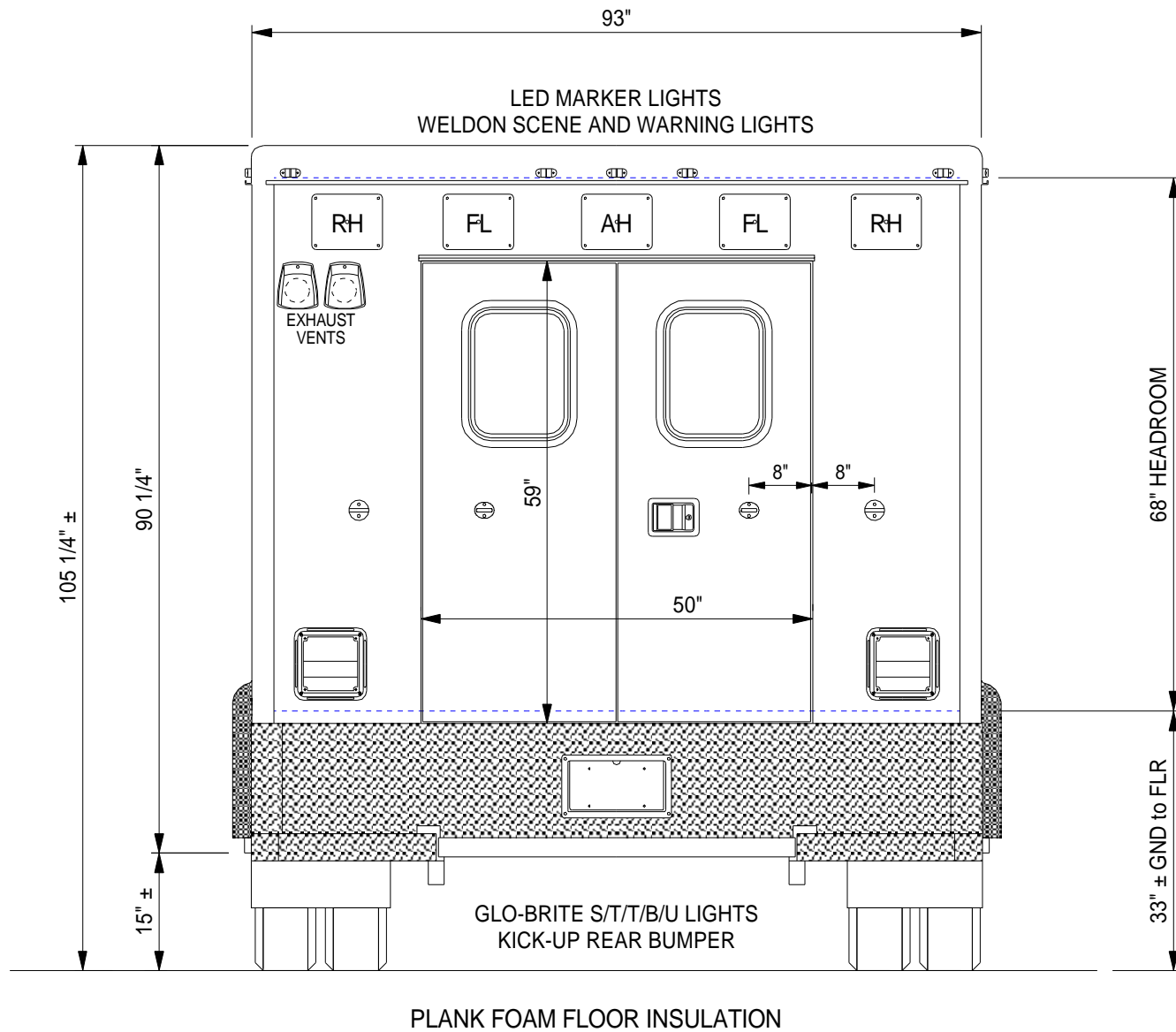

DRAWN BY: MAM
DATE: 11-13-06

Drawing is representative only - Dimensions shown are approximate and may vary from the completed vehicle. DO NOT scale this drawing!

REVISIONS

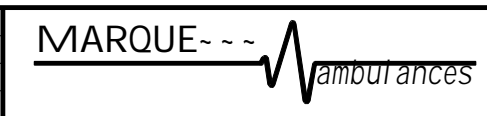

DRAWING TITLE:	REAR EXTERIOR VIEW - 68" HR.
TYPE/MODEL/CHASSIS:	TYPE I - 144 CADET - FORD F350
DEALER / CUSTOMER:	REV/ TACOM
UNIT NUMBER:	4285-96
PRINT NUMBER:	T1-144CADT-002

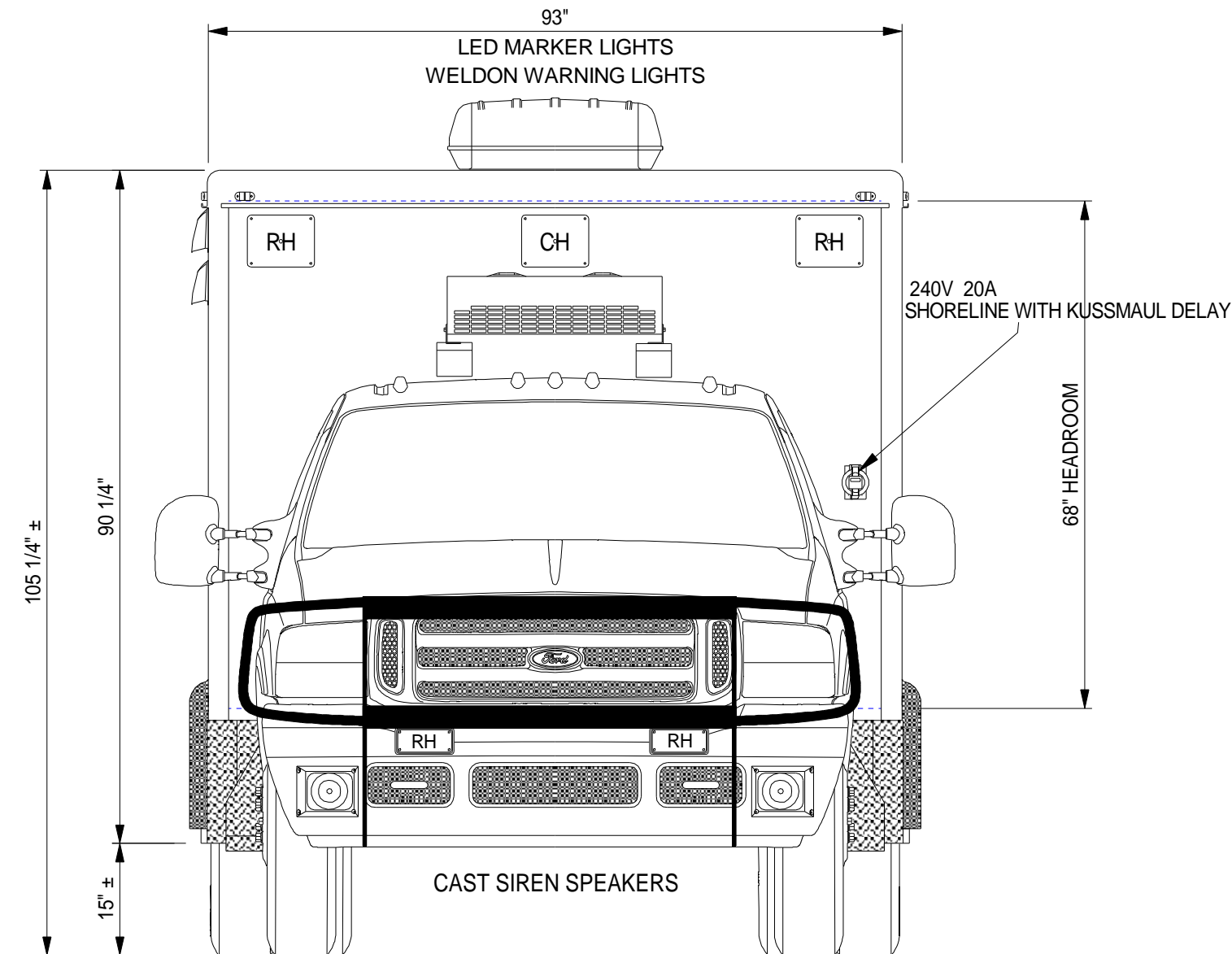

DRAWN BY: MAM
DATE: 11-13-06

Drawing is representative only - Dimensions shown are approximate and may vary from the completed vehicle DO NOT scale this drawing!

REVISIONS

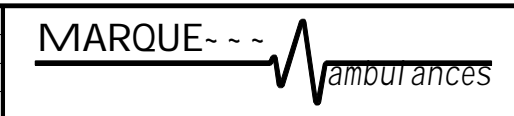

DRAWING TITLE:	FRONT EXTERIOR VIEW - 68" H.R.		
TYPE/MODEL/CHASSIS:	TYPE 1 - 144 CADET - FORD F350		
DEALER / CUSTOMER:	REV/ TACOM		
UNIT NUMBER:	4285-96	PRINT NUMBER:	T1-144CADT-001

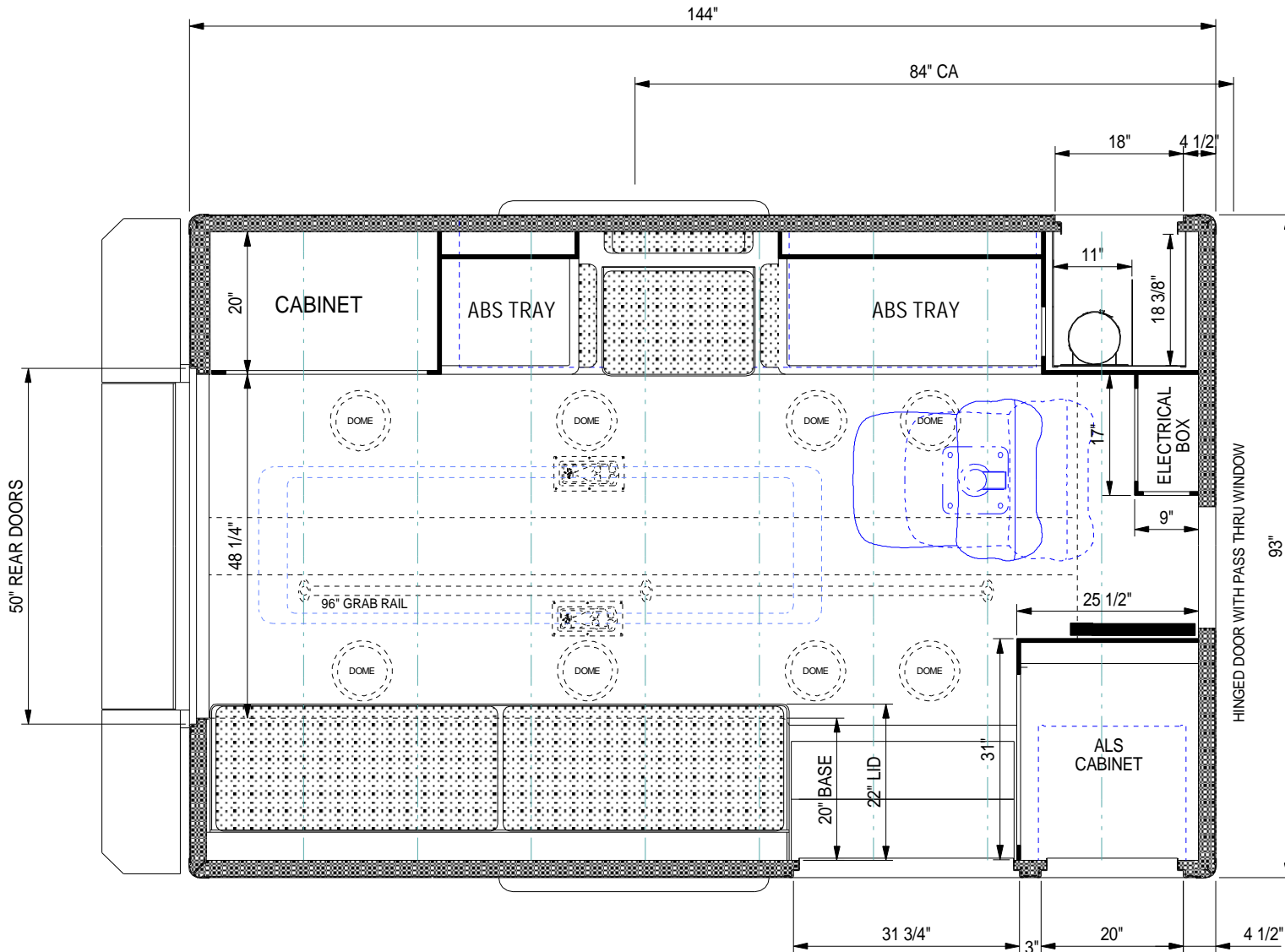

DRAWN BY: MAM
DATE: 11-13-06

REVISIONS

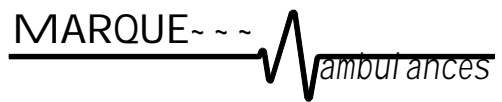

DRAWING TITLE: FLOOR PLAN
TYPE/MODEL/CHASSIS: TYPE I - 144 CADET
DEALER / CUSTOMER: REV/ TACOM

Drawing is representative only - Dimensions shown are approximate and may vary from the completed vehicle DO NOT scale this drawing!

UNIT NUMBER: 4285-96
PRINT NUMBER: T1-144CADT-009